

SANTIAGO CANYON COLLEGE Attachment B

PORTABLE CLASSROOM (U-95) DEMOLITION

100% CONSTRUCTION DOCUMENTS
8045 E. CHAPMAN AVENUE, ORANGE CA 92869

OWNER: RANCHO SANTIAGO COMMUNITY COLLEGE DISTRICT

PROJECT NAME: SANTIAGO CANYON COLLEGE PORTABLE CLASSROOM (U-95) DEMOLITION
100% CONSTRUCTION DOCUMENTS

PROJECT ADDRESS: 8045 E. Chapman Avenue, Orange, CA 92869

THIS PROJECT SHALL COMPLY WITH ALL FEDERAL, STATE AND LOCAL CODES INCLUDING, BUT NOT LIMITED TO, THE FOLLOWING:

FEDERAL:
ADA 2010 STANDARDS FOR ACCESSIBLE DESIGN (ADASAD)

STATE OF CALIFORNIA PARTIAL LIST OF APPLICABLE CODES AS OF JAN 1, 2020

2019 BUILDING STANDARDS ADMINISTRATIVE CODE (CAC)
CALIFORNIA CODE OF REGULATIONS (CCR) PART 1, TITLE 24 C.C.R.

2019 CALIFORNIA BUILDING CODE (CBC)
CALIFORNIA CODE OF REGULATIONS (CCR) TITLE 24, PART 2 (2018 INTERNATIONAL BUILDING CODE, VOL. 1 & VOL. 2, WITH 2016 CALIFORNIA AMENDMENTS)

2019 CALIFORNIA ELECTRICAL CODE (CEC)
CALIFORNIA CODE OF REGULATIONS (CCR) TITLE 24, PART 3 (2017 NATIONAL ELECTRICAL CODE, WITH 2019 CALIFORNIA AMENDMENTS)

2019 CALIFORNIA FIRE CODE
CALIFORNIA CODE OF REGULATIONS (CCR) TITLE 24, PART 9 (2018 INTERNATIONAL FIRE CODE, WITH 2019 CALIFORNIA AMENDMENTS)

2019 CALIFORNIA REFERENCED STANDARDS CODE
CALIFORNIA CODE OF REGULATIONS (CCR) TITLE 24, PART 12

PUBLIC SAFETY, STATE FIRE MARSHAL REGULATIONS
CALIFORNIA CODE OF REGULATIONS (CCR) TITLE 19CCR

PROJECT ADDRESS:
8045 E. CHAPMAN AVENUE
ORANGE, CA 92869

PROJECT DESCRIPTION:
THE PROJECT CONSISTS OF DEMOLISHING PORTABLE U-95 ONLY IN ITS ENTIRETY AND CAPPING OFF AND/OR REROUTING ITS EXISTING UTILITIES. THE EXTERIOR IMPROVEMENTS WILL INVOLVE REGRADE AND PATCHING BACK W/ ASPHALT THE VOID AREA TO MATCH THE EXISTING FINISH GRADE SURROUNDING, ADDING A CHAINLINK FENCE SEGMENT TO ENCLOSE AN EXISTING GUTTER AND DRAINAGE AREA, AND RELOCATING AN EXISTING WALL-MOUNTED DRINKING FOUNTAIN AND ITS CONNECTION(S).

GENERAL
THESE DOCUMENTS AND THE IDEAS AND DESIGNS INCORPORATED HEREIN, AS AN INSTRUMENT OF PROFESSIONAL SERVICE, ARE THE PROPERTY OF SVA ARCHITECTS, INC., AND ARE NOT TO BE USED, IN WHOLE OR IN PART FOR ANOTHER PROJECT WITHOUT THE WRITTEN AUTHORIZATION OF SVA ARCHITECTS, INC.

1. THE WORK SHOWN ON THESE DRAWINGS AS EXISTING CONDITIONS WAS PREPARED FROM INFORMATION FURNISHED BY THE OWNER, WHILE THIS INFORMATION IS BELIEVED TO BE RELIABLE, SVA ARCHITECTS, INC. IS NOT RESPONSIBLE FOR THE ACCURACY OR ADEQUACY OF ANY WORK SHOWN AS EXISTING NOR IS SVA ARCHITECTS, INC. RESPONSIBLE FOR ANY ERRORS OR OMISSIONS WHICH MAY HAVE BEEN INCORPORATED INTO THESE DRAWINGS AS A RESULT.

2. DO NOT SCALE THE DRAWINGS. THE DRAWINGS ARE NOT NECESSARILY TO SCALE. THE CONTRACTOR SHALL VERIFY ALL CONDITIONS AND DIMENSIONS IN THE FIELD PRIOR TO BIDDING AND START OF CONSTRUCTION. IF DISCREPANCIES ARE FOUND, THE ARCHITECT SHALL BE NOTIFIED FOR CLARIFICATION BEFORE COMMENCING WORK.

3. DIMENSIONS AND CONDITIONS AT THE JOB SITE SHALL BE VERIFIED BY ALL CONTRACTORS. IT IS THE RESPONSIBILITY OF THE CONTRACTOR TO EXAMINE THE EXISTING CONDITIONS PRIOR TO SUBMITTING BIDS TO THE OWNER SINCE PROPOSALS MUST TAKE INTO CONSIDERATION ALL SUCH CONDITIONS WHICH MAY AFFECT THE WORK. DISCREPANCIES IN THE DRAWINGS OR BETWEEN THE DRAWINGS AND ACTUAL FIELD CONDITION SHALL BE REPORTED TO THE ARCHITECT. REVISED DRAWINGS OR INSTRUCTIONS SHALL BE ISSUED BY THE OWNER PRIOR TO THE INSTALLATION OF ANY WORK.

4. ALL DIMENSIONS ARE TO FACE OF CONCRETE, FACE OF MASONRY UNITS, CENTERLINE OF COLUMNS AND BEAMS, OR FACE OF STUDS, UNLESS OTHERWISE NOTED. FINISH FLOOR ELEVATIONS ARE TO TOP OF CONCRETE SLAB OR TOP OF INTERIOR PAVING UNLESS NOTED OTHERWISE. CEILING HEIGHT DIMENSIONS ARE TO FINISHED SURFACES UNLESS NOTED OTHERWISE.

5. THE CIVIL, STRUCTURAL, MECHANICAL, PLUMBING, AND ELECTRICAL DRAWINGS ARE SUPPLEMENTAL TO THE ARCHITECTURAL DRAWINGS. IT SHALL BE THE RESPONSIBILITY OF THE CONTRACTOR TO CHECK WITH THE ARCHITECTURAL DRAWINGS BEFORE PROCEEDING WITH INSTALLATION OF CIVIL, STRUCTURAL, MECHANICAL, PLUMBING, AND ELECTRICAL WORK. SHOULD THERE BE ANY DISCREPANCIES BETWEEN THE ARCHITECTURAL AND THE CONSULTING ENGINEER'S DRAWINGS AND SPECIFICATIONS THAT WOULD CAUSE A CONFLICT, IT SHALL BE BROUGHT TO THE ARCHITECT'S ATTENTION FOR CLARIFICATION PRIOR TO INSTALLATION OF SUCH WORK. ANY WORK INSTALLED IN CONFLICT WITH THE ARCHITECTURAL DRAWINGS SHALL BE CORRECTED BY THE CONTRACTOR AT HIS EXPENSE AND AT NO ADDITIONAL COST TO THE OWNER OR ARCHITECT.

6. NO CHANGES ARE TO BE MADE ON THESE PLANS WITHOUT THE KNOWLEDGE OR CONSENT OF THE ARCHITECT/ENGINEER WHOSE SIGNATURE APPEARS HEREON.

7. ALL CONSTRUCTION SHALL BE IN ACCORDANCE WITH THE REQUIREMENTS OF THE APPLICABLE CODES. ALL ENGINEERING SHALL COMPLY WITH ALL APPLICABLE MUNICIPAL, STATE AND FEDERAL REGULATIONS HAVING JURISDICTION INCLUDING ACCESSIBILITY STANDARDS AND ADA REQUIREMENTS.

8. INSPECTOR OF RECORD REQUIREMENTS: A ONE OR MORE INSPECTORS EMPLOYED BY THE OWNER IN ACCORDANCE WITH THE REQUIREMENTS OF TITLE 24 OF THE CALIFORNIA CODE OF REGULATIONS WILL BE ASSIGNED TO THE WORK. THE INSPECTOR DUTIES ARE SPECIFICALLY DEFINED IN SECTION 4-342 OF SAID TITLE 24, PART 1.

9. IT SHALL BE THE DUTY OF THE GENERAL CONTRACTOR TO SEE THAT ALL SUB-CONTRACTORS ARE FULLY INFORMED IN REGARD TO THE GENERAL CONDITIONS AND PRELIMINARY SPECIFICATIONS.

10. INTERPRETATION OF DRAWINGS AND DOCUMENTS: EACH CONTRACTOR SHALL CHECK AND VERIFY ALL DIMENSIONS AND CONDITIONS AT THE PROJECT SITE BEFORE EXECUTING ANY WORK AND SHALL NOTIFY THE OWNER AND THE ARCHITECT OF ANY DISCREPANCIES BEFORE PROCEEDING. THE ARCHITECT SHALL BE NOTIFIED OF ANY DISCREPANCIES AT THE CONDITIONS OR SITUATIONS WHICH MAY AFFECT THE STRUCTURAL INTEGRITY OF SAFETY OF THE PROJECT.

11. ADHERENCE TO PLANS: STRICT ADHERENCE TO THE CONSTRUCTION DOCUMENTS MUST BE MAINTAINED. NO CHANGES SHALL BE MADE IN THE PROJECT WHICH DEVIATE FROM THE PLANS AND SPECIFICATIONS WITHOUT THE WRITTEN CONSENT OF THE ARCHITECT. NO STRUCTURAL CHANGES SHALL BE MADE WITHOUT THE WRITTEN CONSENT OF THE ARCHITECT.

12. SHOP DRAWINGS: CONTRACTOR SHALL SUBMIT COPIES OF ALL SHOP DRAWINGS FOR REVIEW BY DISTRICT ARCHITECT PRIOR TO CONTRACTOR'S APPROVAL. FOR CONSTRUCTION, SUBMIT SHOP DRAWINGS IN ACCORDANCE WITH SECTION 013000 OF SPECIFICATIONS AND AS REQUIRED BY INDIVIDUAL SPECIFICATION SECTIONS.

13. UNLESS OTHERWISE SPECIFIED, ALL MATERIALS SHALL BE NEW AND BOTH WORKMANSHIP AND MATERIALS SHALL BE THE BEST OF THEIR RESPECTIVE KINDS. THE CONTRACTOR SHALL, IF REQUIRED, FURNISH SATISFACTORY EVIDENCE AS THE KIND AND QUALITY OF MATERIALS.

14. THE CONTRACTOR SHALL GIVE PERSONAL SUPERVISION TO THE WORK, USING HIS BEST SKILL AND ATTENTION, AND SHALL KEEP A COMPETENT FOREMAN AND NECESSARY ASSISTANTS CONSTANTLY ON THE SITE. THE FOREMAN SHALL BE THE PERSONAL REPRESENTATIVE OF THE CONTRACTOR AND ALL DIRECTIONS GIVEN BY HIM SHALL BE AS BINDING AS IF GIVEN BY THE CONTRACTOR. COMMUNICATION DELIVERED TO THE FOREMAN BY THE ARCHITECT SHALL BE AS BINDING AS IF DELIVERED TO THE CONTRACTOR. NO SUBSTITUTIONS WILL BE ALLOWED WITHOUT PRIOR WRITTEN APPROVAL. REQUEST FOR SUBSTITUTION SHALL BE IN ACCORDANCE WITH SECTION 013000 OF SPECIFICATIONS.

15. CHANGES TO THE APPROVED DRAWINGS AND SPECIFICATIONS SHALL BE MADE BY AN ADDENDUM OR A CCD APPROVED BY THE DIVISION OF THE STATE ARCHITECT.

16. ALL SYMBOLS AND ABBREVIATIONS USED ON THE DRAWINGS ARE CONSIDERED TO BE CONSTRUCTION STANDARDS IF THE STANDARDS IF THE CONTRACTOR HAS QUESTIONS REGARDING ABBREVIATIONS OR THEIR EXACT MEANING, THE ARCHITECT SHALL BE NOTIFIED FOR CLARIFICATION.

17. DETAILS MARKED "TYPICAL" SHALL APPLY IN ALL SIMILAR CASES UNLESS SPECIFICALLY INDICATED OTHERWISE.

18. CONTRACTOR SHALL PROVIDE AND INSTALL ALL STIFFENERS, BRACING, BACK-UP PLATES, AND SUPPORTING BRACKETS REQUIRED FOR THE INSTALLATION OF ALL DRINKING FOUNTAINS, TOILET ROOM ACCESSORIES AND PARTITIONS, AND OF ALL WALL MOUNTED OR SUSPENDED MECHANICAL, ELECTRICAL, OR MISCELLANEOUS EQUIPMENT.

19. CONTACT BETWEEN DISSIMILAR METAL SHALL BE PROTECTED.

20. THE PROJECT APPLICANT SHALL COMPLY WITH THE REQUIREMENTS OF THE ENGINEERING DIVISION FOR ALL PUBLIC IMPROVEMENTS.

21. **PROTECTION AND SAFETY**
THESE DRAWINGS DO NOT CONTAIN THE NECESSARY COMPONENTS FOR CONSTRUCTION SAFETY.

22. THE CONTRACTOR SHALL BE RESPONSIBLE FOR ALL VIOLATIONS OF CITY ORDINANCES AND STATE LAWS INVOLVED IN THE PERFORMANCE OF HIS WORK. HE SHALL PROVIDE, DURING THE PROGRESS OF HIS WORK, EVERY AND ALL SAFEGUARDS AND PROTECTIONS AGAINST ACCIDENTS, INJURY AND DAMAGE TO PERSONS AND PROPERTY INCLUDING ADJOINING PROPERTY. THE CONTRACTOR SHALL BE RESPONSIBLE FOR HIS WORK AND EVERY PARK THEREOF, AND FOR ALL MATERIALS, TOOLS, EQUIPMENT AND PROPERTY OF EVERY DESCRIPTION USED IN CONNECTION THEREWITH.

23. THE CONTRACTOR ASSUMES ALL RISKS, HAZARDS AND CONDITIONS IN CONNECTION WITH THE PERFORMANCE OF THE CONTRACT, AND EVEN IF THE PERFORMANCE OF THE CONTRACT INVOLVES A GREATER EXPENDITURE OF MONEY THAN THE CONTRACTOR EXPECTED AT THE TIME OF BIDDING, NO ALLOWANCE WILL BE MADE ON ACCOUNT THEREOF, AND THE CONTRACTOR SHALL CONTINUE WITH AND COMPLETE THE WORK.

24. DRINKING WATER SHALL COMPLY WITH ALL ADA CLEARANCES AND REQUIREMENTS.

25. ALL CONSTRUCTION SHALL BE IN ACCORDANCE WITH THE REQUIREMENTS OF THE APPLICABLE CODES.

26. EXIT SIGNS SHALL HAVE 6" MINIMUM HEIGHT LETTERS AND SHALL CONFORM TO SECTION 1012 OF THE CALIFORNIA BUILDING CODE.

27. **SITE WORK**
GRADING PLANS, DRAINAGE IMPROVEMENTS, ROAD AND ACCESS REQUIREMENTS AND ENVIRONMENTAL HEALTH CONSIDERATIONS SHALL COMPLY WITH ALL LOCAL ORDINANCES.

28. ROOF DRAINS DISCHARGING WATER MUST BE CONDUCTED UNDER THE SIDEWALK.

29. LOCATIONS OF ALL UTILITIES SHOWN ARE APPROXIMATE AND CONTRACTOR SHALL EXERCISE EXTREME CAUTION IN EXCAVATING AND TRENCHING ON THIS SITE TO AVOID INTERCEPTING EXISTING PIPING OR CONDUITS. IT SHALL BE THE RESPONSIBILITY OF THE CONTRACTOR TO LOCATE ALL EXISTING UTILITIES WHETHER SHOWN HEREON OR NOT AND TO PROTECT THEM FROM DAMAGE. THE ARCHITECT IS NOT RESPONSIBLE FOR THE LOCATION OF UNDERGROUND UTILITIES OR STRUCTURES WHETHER OR NOT SHOWN OR DETAIL AND INSTALLED BY ANY OTHER CONTRACTOR. THE CONTRACTOR SHALL IMMEDIATELY NOTIFY THE ARCHITECT SHOULD ANY UNIDENTIFIED CONDITIONS BE DISCOVERED. THE CONTRACTOR SHALL BEAR ALL EXPENSE OF REPAIR OR REPLACEMENT OF UTILITIES OR OTHER PROPERTY DAMAGED BY OPERATIONS IN CONJUNCTION WITH THE PROSECUTION OF THIS WORK.

FIRE SAFETY
FIRE SAFETY DURING CONSTRUCTION AND THE DURATION OF THIS CONTRACT:
A. GENERAL: FIRE SAFETY DURING CONSTRUCTION SHALL COMPLY WITH 2019 CALIFORNIA FIRE CODE TITLE 24, PART 9, CHAPTER 33.

B. ACCESS ROADS: FIRE DEPARTMENT ACCESS ROADS SHALL BE ESTABLISHED AND MAINTAINED IN ACCORDANCE WITH SECTION 1410.

C. WATER SUPPLY: WATER MAINS AND HYDRANTS SHALL BE OPERATIONAL IN ACCORDANCE WITH SECTION 1412.

D. BUILDING ACCESS: ACCESS TO BUILDINGS FOR THE PURPOSE OF FIREFIGHTING SHALL BE PROVIDED. CONSTRUCTION MATERIAL SHALL NOT BLOCK ACCESS TO BUILDINGS, HYDRANTS OR FIRE APPLIANCES.

E. FIRE WATCH: MAINTAIN FIRE WATCH WHEN REQUIRED BY THE BUILDING OFFICIAL AND/OR WHEN EXISTING FIRE PROTECTION SYSTEMS ARE SHUT DOWN FOR ALTERATIONS. FIRE WATCH SHALL REMAIN IN EFFECT UNTIL EXISTING FIRE PROTECTION SYSTEMS ARE RETURNED TO SERVICE OR AS ALLOWED BY THE BUILDING OFFICIAL.

2. CONTRACTOR REQUIRED TO COMPLY WITH CURRENT CODE AND CITY STANDARDS.

3. CONTRACTOR IS RESPONSIBLE FOR FIRE SAFETY DURING CONSTRUCTION AND THE DURATION OF THIS CONTRACT PER 2019 CALIFORNIA FIRE CODE, CHAPTER 33.

DRINKING FOUNTAINS
1. ON ANY FLOOR WHERE DRINKING FOUNTAINS ARE PROVIDED, THERE SHALL BE A DRINKING FOUNTAIN THAT IS ACCESSIBLE TO INDIVIDUALS WHO USE WHEELCHAIRS AND ONE ACCESSIBLE TO THOSE WHO HAVE DIFFICULTY BENDING OR STOOPING ("HI-LO" FOUNTAIN), PER CBC 11B-211.2, WHERE MORE THAN ONE IS PROVIDED ON A FLOOR, 50% SHALL COMPLY WITH THESE REQUIREMENTS PER CBC 11B-211.3.

2. THE DRINKING FOUNTAIN SHALL BE A MINIMUM OF 18 INCHES AND A MAXIMUM OF 19 INCHES IN DEPTH AND THERE SHALL BE A CLEAR AND UNOBSTRUCTED KNEE SPACE UNDER THE DRINKING FOUNTAIN NOT LESS THAN 27 INCHES IN HEIGHT, 30 INCHES IN WIDTH, AND 8 INCHES IN DEPTH, THE DEPTH MEASUREMENT BEING TAKEN FROM THE FRONT EDGE OF THE FOUNTAIN. ADDITIONALLY THERE SHALL BE A CLEARANCE OF 8 INCHES IN HEIGHT ABOVE THE FLOOR, AND 17 INCHES IN DEPTH FROM THE FRONT EDGE OF THE FOUNTAIN. A SIDE APPROACH DRINKING FOUNTAIN IS NOT ACCEPTABLE.

3. THE BUBBLER SHALL BE ACTIVATED BY A CONTROL WHICH IS EASILY OPERATED BY A DISABLED PERSON SUCH AS A HAND-OPERATED LEVER TYPE LOCATED WITHIN 1 INCHES OF THE FRONT OF THE DRINKING FOUNTAIN, ETC. THE BUBBLER OUTLET ORIFICE SHALL BE LOCATED WITHIN 6 INCHES OF THE FRONT OF THE DRINKING FOUNTAIN AND SHALL BE WITHIN 36 INCHES OF THE FRONT EDGE OF THE DRINKING FOUNTAIN. THE SPOUT SHALL PROVIDE A FLOW OF WATER THAT IS AT LEAST 4 INCHES HIGH SO AS TO ALLOW THE INSERTION OF A CUP OR GLASS UNDER THE FLOW OF WATER. THE FORCE REQUIRED TO ACTIVATE THE CONTROLS SHALL BE NO GREATER THAN 5 LB.

A.C.	ACCOUS	A.B.	ANCHOR BOLT (S)	M.C.	MEDICINE CABINET
A.D.	ADJUSTABLE	ASPH.	ASPHALT	M.E.	MECHANICAL MEMBRANE
AGG.	AGGREGATE	ASPH. A.S.T.M.	AMERICAN SOCIETY OF TESTING MATERIALS	MET.	METAL
ALUM.	ALUMINUM	AT	AT	M.F.	MANUFACTURE
APPROX.	APPROXIMATE	B.B.	BOTTOM OF BEAM	M.H.	MAN HOLE
APR.	APARTMENT	BD.	BOARD	MIN.	MINIMUM
ASPH.	ASPHALT	BLK.	BLOCK	MIR.	MIRROR
B.R.	BROOM	BM.	BEAM	MTG.	MOUNTING
B.T.	BOTTOM	BT.	BOTTOM	MTL.	METAL
BRM.	BROOM	BUM.	BUMPER	N.	NORTH
B.R.	BROOM	BU.	BUMPER	NAT.	NATURAL
		BY.	BYE	N.I.C.	NOT IN CONTRACT
		CB.	CABINET	N.O.	NUMBER
		C.C.	CATCH BASIN	N.T.S.	NOT TO SCALE
		CEM.	CEMENT	O.	OVER
		CEM. PLAS.	CEMENT PLASTER	O.C.	ON CENTER
		CL.	CENTER LINE	OPP.	OPPOSITE
		CLG.	CLEAR	OV.	OVEN
		CLR.	CLEAR	OVHD.	OVERHEAD
		C.M.T.	CERAMIC MOSAIC TILE	FB.	PUSHBUTTON
		COMP.	CONCRETE	PC.	PULL CHAIN
		CONT.	CONTINUOUS	PL.	PLATE
		CONT.	CONTINUOUS	PLAS.	PLASTER
		CU FT.	CUBIC FEET	PL. GLS.	PLATE GLASS
		CU. IN.	CUBIC INCH	PLAST.	PLASTER
		CU. YD.	CUBIC YARD	PLYWOOD	PLYWOOD
		D.	DRYER	PNL.	PANEL
		D.F.	DRINKING FOUNTAIN	PR.	PAIR
		DIA.	DIAMETER	PRECAST.	PREFABRICATED
		DIM.	DIMENSION	PERC.	PERCENT
		DN.	DOWN	QTY.	QUANTITY
		DR.	DRY	RAD.	RADIUS
		D.S.	DRY STANDPIPE	R.	RISER
		DSP.	DRY STANDPIPE	R.A.G.	RETURN AIR GRILLE
		DUP.	DUPLICATE	R.D.	ROOF DRAIN
		DW.	DRAWINGS	RECP.	RECEPTACLE
		D.W.G.S.	DRAWINGS	REF.	REFERENCE
		E.	EAST	REG.	REGISTER
		E.A.	EACH	REIN.	REINFORCEMENT
		E.E.	EXPANSION JOINT	RECORD.	RECORDED
		ELEV.	ELEVATION	RES. FLR.	RESILIENT FLOORING
		ENCL.	ENCLOSURE	RET.	RETAINING
		EQU.	EQUIPMENT	RF.	ROOF
		EXP.	EXPOSED	RFG.	ROOFING
		EXTR.	EXTINGUISHER	RM.	ROOM
		F.H.S.	FLAT HEAD SCREW	R.O.	ROUGH OPENING
		F.A.U.	FORCED AIR UNIT	RUB.	RUBBER (RESILIENT) BASE
		F.F.	FINISH FLOOR	S.	SOUTH
		F.F.W.	FIXED GLASS	S.C.	SOLID CORE
		F.H.W.S.	FLAT HEAD WOOD SCREW	S.D.	STORM DRAIN
		FN.	FINISH	SHT.	SHEET
		FIXT.	FIXTURE	SHT'G.	SHOOTING
		FLASH.	FLASHING	SIM.	SIMILAR
		FLR.	FLOOR	SHP.	SHELF AND POLE
		FLUOR.	FLUORESCENT	SPEC.	SPECIFICATIONS
		F.O.C.	FACE OF CONCRETE	SPRINKL.	SPRINKLER
		F.O.S.	FACE OF MASONRY	SQ. FT.	SQUARE FOOT
		F.O.W.	FACE OF WALL	ST.	STEEL
		F.F.S.	FINISH SURFACE	STOR.	STORAGE
		FREQ.	FREQUENCY	STRUC.	STRUCTURAL
		FT.	FEET	SUSP.	SUSPENDED
		FTC.	FIRE EXTINGUISHER & CABINET	SIM.	SIMILAR
		G.	GAUGE	S.S.	SMOOTH FOUR SIDES STAINLESS STEEL
		GALV.	GALVANIZED	T.	TREAD
		GUN.	GUNITE	T&B	TOP AND BOTTOM
		GYP.	GYPSONUM	T.C.	TOP OF CURB
		GYP. BD.	GYPSONUM BOARD	T.C.	TOP OF CONCRETE
		H.C.	HOLLOW CORE	T.G.	TOP OF GRADE
		HO.	HOLE	TEL.	TELEPHONE
		HD.	HOLLOW	TEMP.	TEMPERED
		H.M.	HOLLOW METAL	T&T	TONGUE AND GROOVE THICK
		HR.	HORIZONTAL	THK.	THICK
		I.	IRON	THRESH.	THRESHOLD
		I.D.	INSIDE DIAMETER	T.S.	TOP OF SHEATHING
		INC.	INCORPORATED	T.W.	TOP OF WALL
		INSUL.	INSULATION	TYP.	TYPICAL
		INT.	INTERIOR	UL.	UNDERWRITER'S LABEL
		INT.	INTERIOR	UL.T.	UNFINISHED
		J.	JOINT	U.R.F.	UNDER ROOF FRAMING
		JST.	JOIST	V.A.T.	VINYL ASBESTOS TILE
		K.	KITCHEN	VENT.	VENTILATOR
		LAM.	LAMINATED	VERT.	VERTICAL
		LAM. PLAS.	LAMINATED PLASTIC	VIT.	VITREOUS
		LA.	LAVATORY	VOL.	VOLUME
		LT.	LIGHT	V.V.T.	VINYL TILE
		LVR.	LOUVER	W.	WEST
				W.	WITH
				W.C.	WATER CLOSET
				WOOD.	WOOD
				W.	WIDE FLANGE (STEEL)
				W.G.	WIRE GLASS
				W.H.	WATER HEATER
				W.I.	WROUGHT IRON
				W/O.	WITHOUT
				WP.	WATERPROOFING
				WS.	WEATHERSTRIPPING
				W.S.P.	WET STANDPIPE
				WT.	WEIGHT
				YD.	YARD

APPLICABLE CODES	PROJECT SUMMARY
SVA ARCHITECTS IS THE DESIGNATED ARCHITECT OF RECORD AS REQUIRED BY THE STATE OF CALIFORNIA. THE ARCHITECT OF RECORD SHALL REVIEW SUBMITTALS AND COORDINATE SUBMITTALS AND DEFERRED SUBMITTALS THROUGH THE DIVISION OF THE STATE ARCHITECT. DEFERRED SUBMITTALS SHALL NOT BE INSTALLED UNTIL THEIR DESIGN AND SUBMITTAL DOCUMENTS HAVE BEEN APPROVED BY THE DIVISION OF THE STATE ARCHITECT.	OWNER RANCHO SANTIAGO COMMUNITY COLLEGE DISTRICT 2323 N. BROADWAY, SUITE 111 SANTA ANA, CA 92706-1640
DSA SHALL BE NOTIFIED IN WRITING BY THE OWNER IF THE ARCHITECT OF RECORD IS CHANGED OR IS UNABLE TO CONTINUE TO PERFORM THE DUTIES. THE OWNER SHALL DESIGNATE A SUBSTITUTE ARCHITECT OR ENGINEER OF RECORD WHO SHALL PERFORM ALL OF THE DUTIES REQUIRED OF THE ORIGINAL ARCHITECT OF RECORD.	CONTACT: CHI KWAN FONG T: 949.569.0885
REVIEW AND COMMENT ON SUBMITTALS AND DEFERRED SUBMITTALS SHALL NOT RELIEVE THE AUTHOR OF THE DOCUMENTS OR THE CONTRACTOR FROM COMPLIANCE WITH ALL APPLICABLE CODES AND THE REQUIREMENTS OF THE DRAWINGS AND SPECIFICATIONS. THE REVIEW IS ONLY FOR GENERAL CONFORMANCE WITH THE DESIGN CONCEPT OF THE PROJECT AND GENERAL COMPLIANCE WITH INFORMATION GIVEN IN THE CONTRACT DOCUMENTS. THE CONTRACTOR IS RESPONSIBLE FOR CONFIRMING AND CORRELATING ALL QUANTITIES AND DIMENSIONS, SELECTING FABRICATION PROCESSES AND TECHNIQUES OF CONSTRUCTION, COORDINATING HIS WORK WITH THAT OF OTHER TRADES, AND PERFORMING HIS WORK IN A SAFE AND SATISFACTORY MANNER.	ARCHITECT SVA ARCHITECTS 6 HUTTON CENTRE DRIVE, SUITE 1150 SANTA ANA, CA 92707
	CONTACT: DANIEL RUIZ T: 714.309.3254

ARCHITECT OF RECORD	PROJECT DIRECTORY
1. ALL WORK SHALL CONFORM TO TITLE 24, CALIFORNIA CODE OF REGULATIONS (CCR).	
2. CHANGES TO THE APPROVED DRAWINGS AND SPECIFICATIONS SHALL BE MADE BY AN ADDENDUM OR A CONSTRUCTION CHANGE DOCUMENT (CCD) APPROVED BY THE DIVISION OF THE STATE ARCHITECT (DSA) AS REQUIRED BY SECTION 4-338, PART 1, TITLE 24, CCR.	
3. A PROJECT INSPECTOR EMPLOYED BY THE DISTRICT (OWNER) AND APPROVED BY DSA SHALL PROVIDE CONTINUOUS INSPECTION OF THE WORK. THE DUTIES OF THE INSPECTOR ARE DEFINED IN SECTION 4-342, PART 1, TITLE 24, CCR CLASS 3.	
4. CHANGE TO THE APPROVED DRAWINGS AND SPECIFICATIONS SHALL BE MADE BY ADDENDA OR CONSTRUCTION CHANGE DOCUMENT (CCD) APPROVED BY DSA, AS REQUIRED BY SECTION 4-338, PART 1, TITLE 24, CCR.	
5. A COPY OF CCR TITLE 24, PARTS 1 THROUGH 5 MUST BE KEPT ON SITE DURING CONSTRUCTION.	
6. A DSA ACCEPTED TESTING LABORATORY DIRECTLY EMPLOYED BY THE DISTRICT (OWNER) SHALL CONDUCT ALL REQUIRED TEST AND INSPECTIONS FOR THE PROJECT.	
7. THE INTENT OF THESE DRAWINGS AND SPECIFICATIONS IS THAT THE WORK OF THE ALTERATION, REHABILITATION OR RECONSTRUCTION IS TO BE IN ACCORDANCE WITH TITLE 24, CCR, SHOULD ANY EXISTING CONDITIONS SUCH AS DETERIORATION OR NON-COMPLYING CONSTRUCTION BE DISCOVERED WHICH IS NOT COVERED BY THE CONTRACT DOCUMENTS WHEREIN THE FINISHED WORK WILL NOT COMPLY WITH TITLE 24, CCR, A CONSTRUCTION CHANGE DOCUMENT (CCD), OR A SEPARATE SET OF PLANS AND SPECIFICATIONS, DETAILING AND SPECIFYING THE REQUIRED WORK SHALL BE SUBMITTED TO AND APPROVED BY DSA BEFORE PROCEEDING WITH THE WORK (SECTION 4-317(c), PART 1, TITLE 24, CCR).	
8. GRADING PLANS, DRAINAGE IMPROVEMENTS, ROAD AND ACCESS REQUIREMENTS AND ENVIRONMENTAL HEALTH CONSIDERATIONS SHALL COMPLY WITH ALL LOCAL ORDINANCES.	
9. FIRE SAFETY DURING DEMOLITION & CONSTRUCTION SHALL COMPLY WITH CFC CHAPTER 33.	

PREVIOUS DSA APPROVALS	PROJECT DIRECTORY
# 04-107789 MASS GRADING PHASE 2 - SITE IMPVTS. AND RELOCATION OF 22 - CR BLDGS. CERT. AND CLOSED #1 (2015)	
# 04-114123 ADA IMPVTS. PHASE 1 CERT. AND CLOSED #1 (2017)	
# 04-116590 BARRIER REMOVAL EXT. PARKING - (PHASE 1) CERT. AND CLOSED #1 (2018)	
# 04-116790 BARRIER REMOVAL EXT. PATH OF TRAVEL - (PHASE 2) CERT. AND CLOSED #1 (2019)	
# 04-116970 BARRIER REMOVAL P.T.D. REPLACEMENT, TYP. CERT. AND CLOSED #1 (2020)	
# 04-117460 SAFETY AND SECURITY BLDG. CERT. AND CLOSED #1 (2020)	

PREVIOUS DSA APPROVALS	PROJECT DIRECTORY
1. DESIGN INTENT AND APPEARS TO MEET THE APPROPRIATE REQUIREMENTS OF TITLE 24, CALIFORNIA CODE OF REGULATIONS AND THE PROJECT SPECIFICATIONS PREPARED BY ME	
2. COORDINATION WITH MY PLANS AND SPECIFICATIONS AND IS ACCEPTABLE FOR INCORPORATION INTO THE CONSTRUCTION OF THE PROJECT.	

THIS STATEMENT OF GENERAL CONFORMANCE "SHALL" NOT BE CONSTRUED AS RELIEVING ME OF MY RIGHTS, DUTIES AND RESPONSIBILITIES UNDER SECTION 17922 AND 81158 OF THE EDUCATION CODE AND SECTION 4-336, 4-341 AND 4-344 OF TITLE 24, PART 1 (TITLE 24, PART 1 SECTION 4-317) (B)

STATEMENT OF GENERAL CONFORMANCE	GENERAL CONFORMANCE STATEMENT
1. DESIGN INTENT AND APPEARS TO MEET THE APPROPRIATE REQUIREMENTS OF TITLE 24, CALIFORNIA CODE OF REGULATIONS AND THE PROJECT SPECIFICATIONS PREPARED BY ME	I CERTIFY THAT ALL DRAWINGS OR SHEETS LISTED IN THE INDEX ON THIS SHEET (CIVIL) ARE IN GENERAL CONFORMANCE AND HAVE BEEN COORDINATED.
2. COORDINATION WITH MY PLANS AND SPECIFICATIONS AND IS ACCEPTABLE FOR INCORPORATION INTO THE CONSTRUCTION OF THE PROJECT.	

GENERAL CONFORMANCE STATEMENT	GENERAL CONFORMANCE STATEMENT
1. DESIGN INTENT AND APPEARS TO MEET THE APPROPRIATE REQUIREMENTS OF TITLE 24, CALIFORNIA CODE OF REGULATIONS AND THE PROJECT SPECIFICATIONS PREPARED BY ME	I CERTIFY THAT ALL DRAWINGS OR SHEETS LISTED IN THE INDEX ON THIS SHEET (CIVIL) ARE IN GENERAL CONFORMANCE AND HAVE BEEN COORDINATED.
2. COORDINATION WITH MY PLANS AND SPECIFICATIONS AND IS ACCEPTABLE FOR INCORPORATION INTO THE CONSTRUCTION OF THE PROJECT.	

GENERAL CONFORMANCE STATEMENT	GENERAL CONFORMANCE STATEMENT
1. DESIGN INTENT AND APPEARS TO MEET THE APPROPRIATE REQUIREMENTS OF TITLE 24, CALIFORNIA CODE OF REGULATIONS AND THE PROJECT SPECIFICATIONS PREPARED BY ME	I CERTIFY THAT ALL DRAWINGS OR SHEETS LISTED IN THE INDEX ON THIS SHEET (CIVIL) ARE IN GENERAL CONFORMANCE AND HAVE BEEN COORDINATED.
2. COORDINATION WITH MY PLANS AND SPECIFICATIONS AND IS ACCEPTABLE FOR INCORPORATION INTO THE CONSTRUCTION OF THE PROJECT.	

GENERAL CONFORMANCE STATEMENT	GENERAL CONFORMANCE STATEMENT
1. DESIGN INTENT AND APPEARS TO MEET THE APPROPRIATE REQUIREMENTS OF TITLE 24, CALIFORNIA CODE OF REGULATIONS AND THE PROJECT SPECIFICATIONS PREPARED BY ME	I CERTIFY THAT ALL DRAWINGS OR SHEETS LISTED IN THE INDEX ON THIS SHEET (CIVIL) ARE IN GENERAL CONFORMANCE AND HAVE BEEN COORDINATED.
2. COORDINATION WITH MY PLANS AND SPECIFICATIONS AND IS ACCEPTABLE FOR INCORPORATION INTO THE CONSTRUCTION OF THE PROJECT.	

CONT. GENERAL NOTES	ARCHITECTURAL SYMBOLS LEGEND
DETAIL REFERENCE DETAIL NUMBER → 1 SHEET ON WHICH DETAIL IS SHOWN → A101	REVISIONS REVISION NUMBER → 1 WALL TYPES

NOTES:
 1. PROVIDE DUST CONTROL AS REQ'D. DURING DEMOLITION & ASPHALT PAVEMENT COMPACTION AND INSTALLATION TYP. U.N.O.

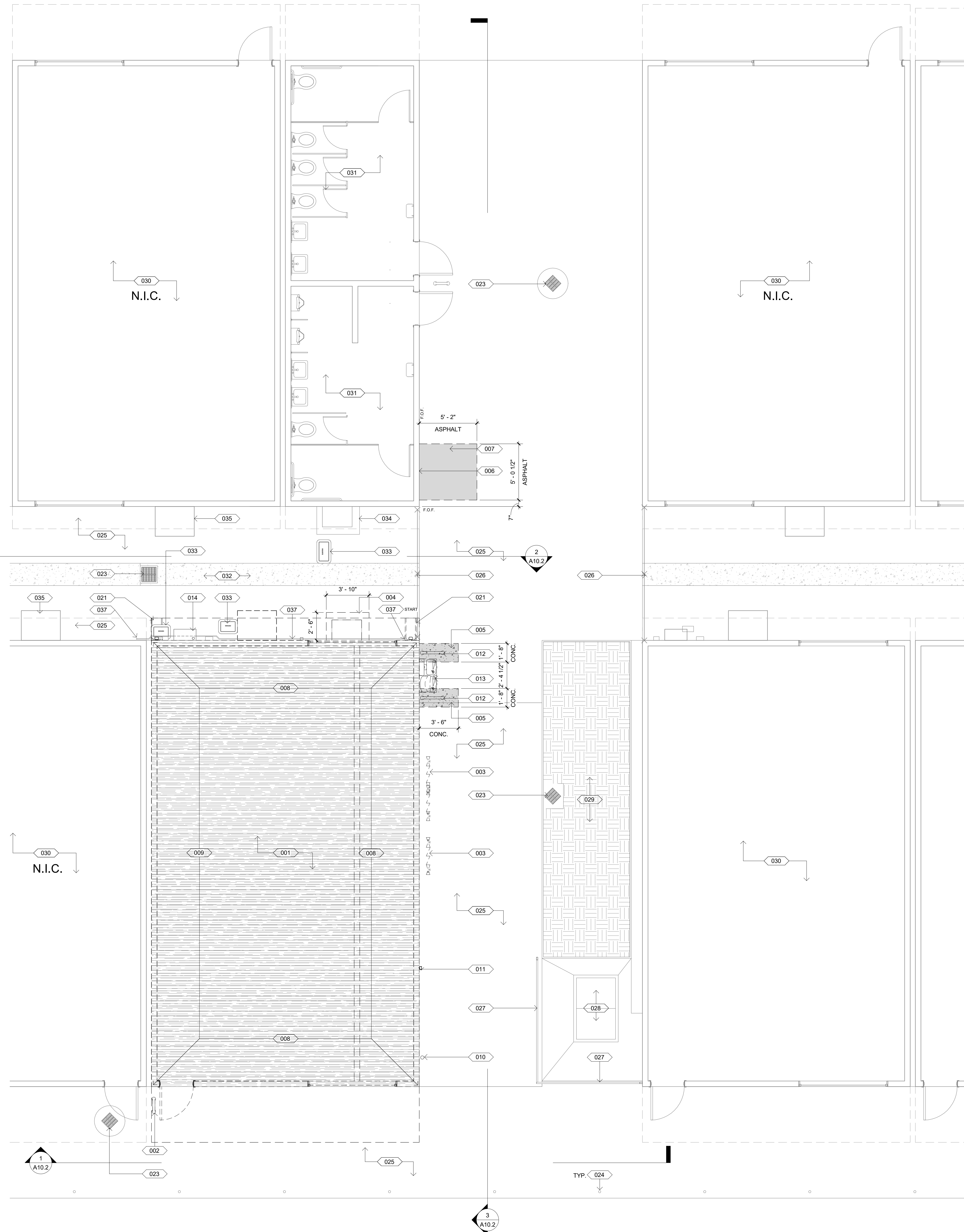

- | # | DESCRIPTION |
|-----|----------------------------------------------------------------------------------------------------------------------------------------------------------------------------------------------------------------------------------------|
| 001 | REMOVE EXISTING PORTABLE CLASSROOM IN ITS ENTIRETY - CAP-OFF ONLY THE UTILITIES SERVING THE INDIVIDUAL UNIT AND SALVAGE, PROTECT-IN-PLACE AND/OR RE-ROUTE THE UTILITIES SERVING OTHER PORTABLE UNITS, U.N.O. |
| 002 | EXISTING FLOOR MOUNTED STEEL PIPE GUARDRAIL TO BE REMOVED IN ITS ENTIRETY |
| 003 | EXISTING FLOOR MOUNTED DOUBLE CHECK DETECTOR ASSEMBLY TO BE REMOVED IN ITS ENTIRETY |
| 004 | EXISTING C.M.U. STEM WALL TO BE DEMOLISHED IN ITS ENTIRETY |
| 005 | SAWCUT AND REMOVE EXISTING CONCRETE PAVING, AS INDICATED |
| 006 | VERIFY EXISTING FIELD CONDITIONS PRIOR TO CUTTING-OUT OPNGS. ON THE WALL FOR PLUMBING AND ELECTRICAL CONNECTIONS FROM PORTABLE RESTROOMS (E) INFRASTRUCTURE - REFER TO IMPRVTS. PLAN FOR RELOCATION OF EXISTING DRINKING FOUNTAIN |
| 007 | SAWCUT AND REMOVE EXISTING ASPHALT CONCRETE PAVEMENT AS REQ'D. FOR A NEW CONCRETE BASE TO INSTALL (E) STL. PIPE GUARDRAIL ON EACH SIDE OF RELOCATED DRINKING FOUNTAIN - REFER TO IMPRVTS. PLAN FOR RELOCATION |
| 008 | REMOVE EXISTING PORTABLE CLASSROOM UNIT'S PERIMETER FLOOR BEAM AND ITS FOUNDATION SILL PLATES AND BLK'G. IN ITS ENTIRETY |
| 009 | REMOVE ONLY EXISTING PORTABLE CLASSROOM UNIT'S FLOOR BEAM AND ITS LAG SCREWS AND PROTECT-IN-PLACE THE (E) SHARED FOUNDATION ASSEMBLY - REFER TO DETAIL 4 / A10.2 |
| 010 | EXISTING FREE-STANDING WATER CONNECTION PIPE TO BE REMOVED AND RELOCATED AT A NEW LOCATION IN A NEW UNDERGROUND YARD BOX - PROVIDE SHUT-OFF VALVE FOR FUTURE CONNECTION IN (N) YARD BOX |
| 011 | EXISTING WALL MOUNTED DOWNSPOUT TO BE REMOVED IN ITS ENTIRETY, REUSE AND RELOCATED - REFER TO IMPRVTS. PLANS AND ELEVS. FOR RELOCATION OF EXISTING DOWNSPOUT |
| 012 | EXISTING DRINKING FOUNTAIN HANDRAIL AND BASE PLATE TO BE REMOVED, SALVAGED AND REUSED - REFER TO IMPRVTS. PLANS AND ELEVS. FOR RELOCATION |
| 013 | EXISTING WALL-MOUNTED HI-LOW DRINKING FOUNTAIN AND ITS STAINLESS STEEL BACK PANEL TO BE REMOVED CAREFULLY, SALVAGED AND RELOCATED IN PHASE 1 - REFER TO IMPRVTS. PLANS AND ELEVS. FOR RELOCATION |
| 014 | EXISTING WALL-MOUNT COMMUNICATION BOX PANEL TO REMAIN, SALVAGED, REUSED AND BE PROTECTED-IN-PLACE. PRIOR TO COMMENCING ANY WORK, BUILD AND PROVIDE A TEMPORARY ENCLOSURE TO STABILIZE AND ANCHOR THE (E) BOX PANEL. SEE DETAIL 6/A11.2 |
| 021 | EXISTING CONCRETE SPLASH BLOCK TO BE SALVAGED AND GIVEN TO THE DISTRICT |
| 023 | EXISTING SITE CATCH BASIN TO REMAIN AND BE PROTECTED-IN-PLACE. PROVIDE INLET PROTECTION DURING THE DEMOLITION AND SITE CONSTRUCTION |
| 024 | EXISTING STEEL PIPE GUARDRAIL WITH CABLE RAILING TO REMAIN AND BE PROTECTED-IN-PLACE |
| 025 | EXISTING ASPHALT PAVEMENT TO REMAIN AND BE PROTECTED-IN-PLACE, AS INDICATED |
| 026 | EXISTING CHAINLINK DOUBLE-GATE AND END POST TO REMAIN AND BE PROTECTED-IN-PLACE |
| 027 | EXISTING STEEL PIPE GUARDRAIL TO REMAIN AND BE PROTECTED-IN-PLACE |
| 028 | PROTECT-IN-PLACE EXISTING COMMUNICATION VAULT |
| 029 | EXISTING LAWN AREA TO REMAIN |
| 030 | PROTECT IN-PLACE EXISTING ADJACENT PORTABLE CLASSROOM UNIT IN ITS ENTIRETY AT ALL TIMES DURING DEMOLITION AND CONSTRUCTION |
| 031 | PROTECT IN-PLACE EXISTING RESTROOM BLDG. AT ALL TIMES DURING DEMO. AND CONSTRUCTION, U.N.O. - REFER TO IMPRVTS. PLANS AND ELEVS. FOR IMPRVTS. AND NEW REQ'D. CONNECTIONS |
| 032 | EXISTING CONCRETE V-GUTTER TO REMAIN AND BE PROTECTED-IN-PLACE AT ALL TIMES DURING DEMOLITION AND CONSTRUCTION |
| 033 | PROTECT-IN-PLACE EXISTING UNDERGROUND CONCRETE UTILITY PULL BOX |
| 034 | EXISTING C.M.U. STEM WALL OPNG. TO REMAIN AND BE PROTECTED-IN-PLACE |
| 035 | PROTECT-IN-PLACE ALL EXTERIOR WALL-MOUNT MECHANICAL AND ELECTRICAL EQUIPMENT FROM OTHER ADJACENT PORTABLE CLASSROOMS NOT IN SCOPE, TYP. |
| 037 | PROTECT-IN-PLACE EXISTING TEMP. 3/4" LIQUID TIGHT FIRE ALARM CONDUIT LINE BEING ROUTED FROM BELOW GRADE TO PORTABLE UNIT U-94 PRIOR TO DEMOLITION WORK AND AT ALL TIMES DURING DEMOLITION AND CONSTRUCTION OF IMPV'TS. |

KEYNOTES

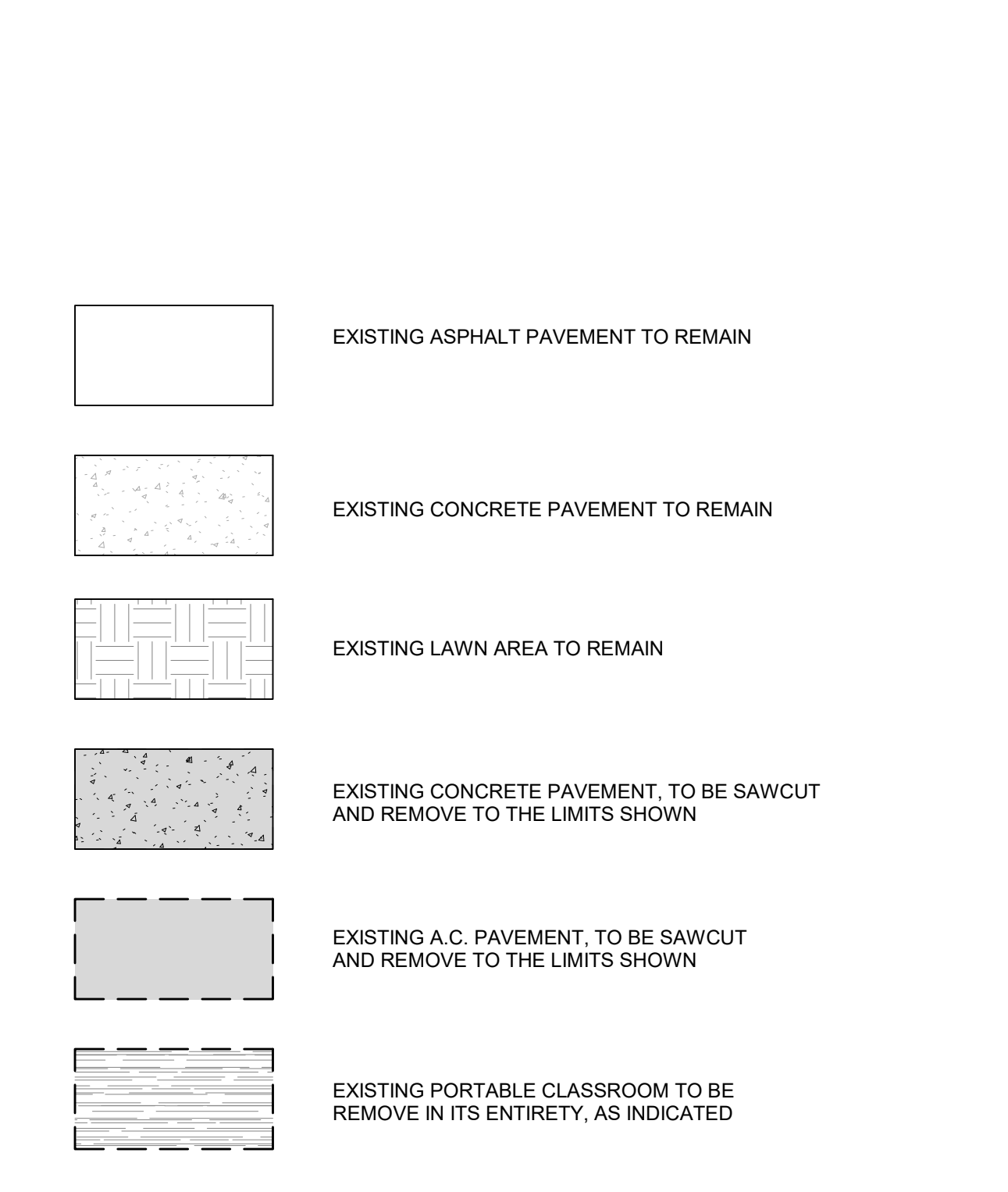

OWNER: RANCHO SANTIAGO COMMUNITY COLLEGE DISTRICT
PROJECT NAME: SANTIAGO CANYON COLLEGE PORTABLE CLASSROOM (U-95) DEMOLITION 100% CONSTRUCTION DOCUMENTS
 PROJECT ADDRESS: 8045 E. Chapman Avenue, Orange, CA 92869

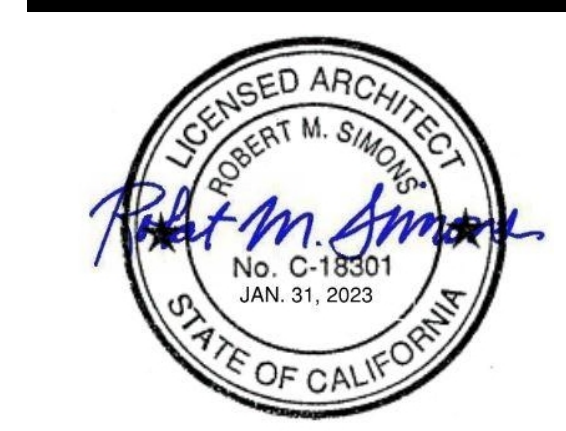

REVISIONS:

NO.	DESCRIPTION	DATE

SET: 100% CD - 10/04/2021
 PROJECT NO: 2021-40121
 SCALE: As indicated

SHEET NUMBER: **A10.1**
 SHEET TITLE:

DEMOLITION - LEVEL 1 FLOOR PLAN



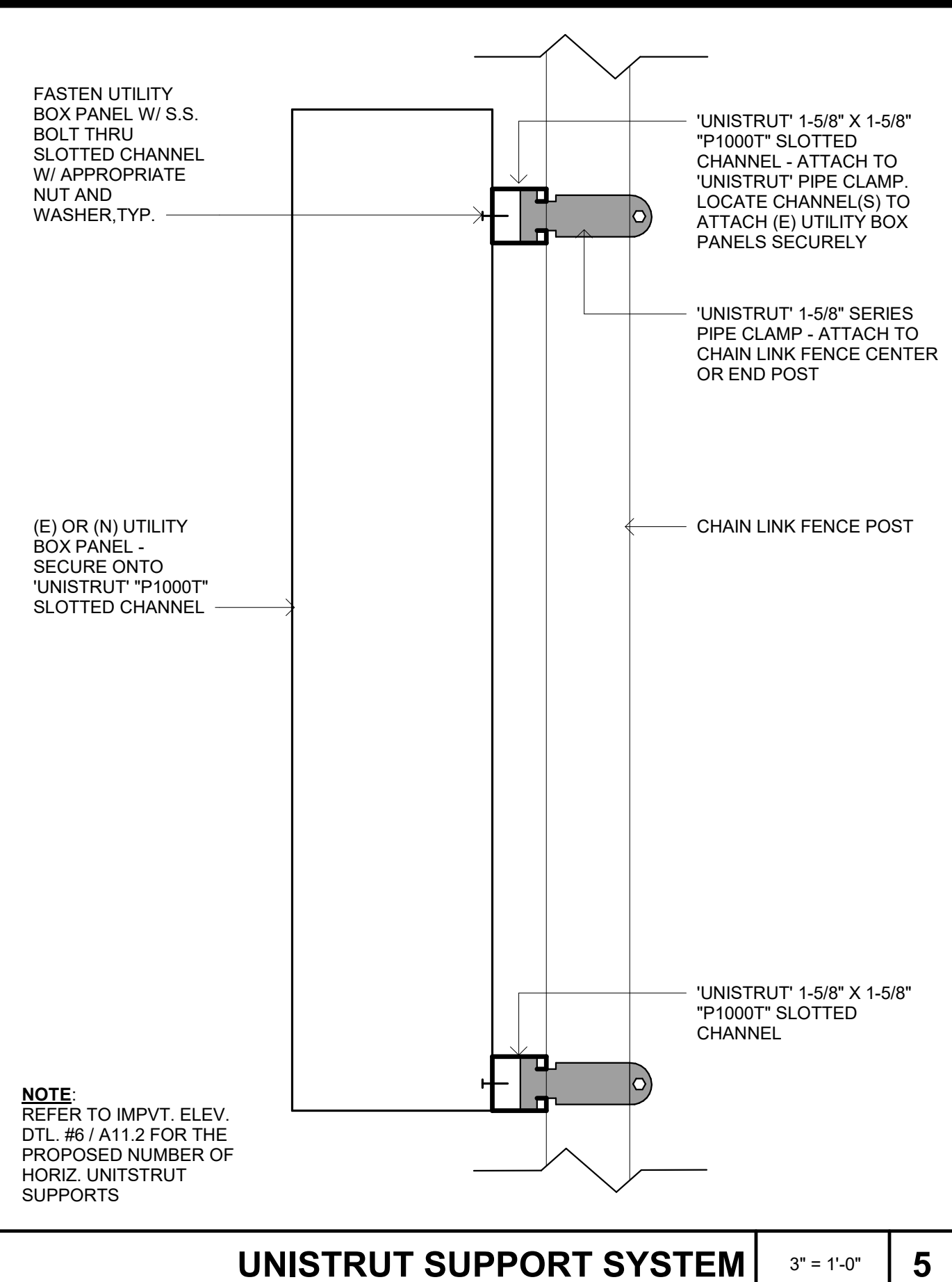

UNISTRUT SUPPORT SYSTEM 3" = 1'-0" 5

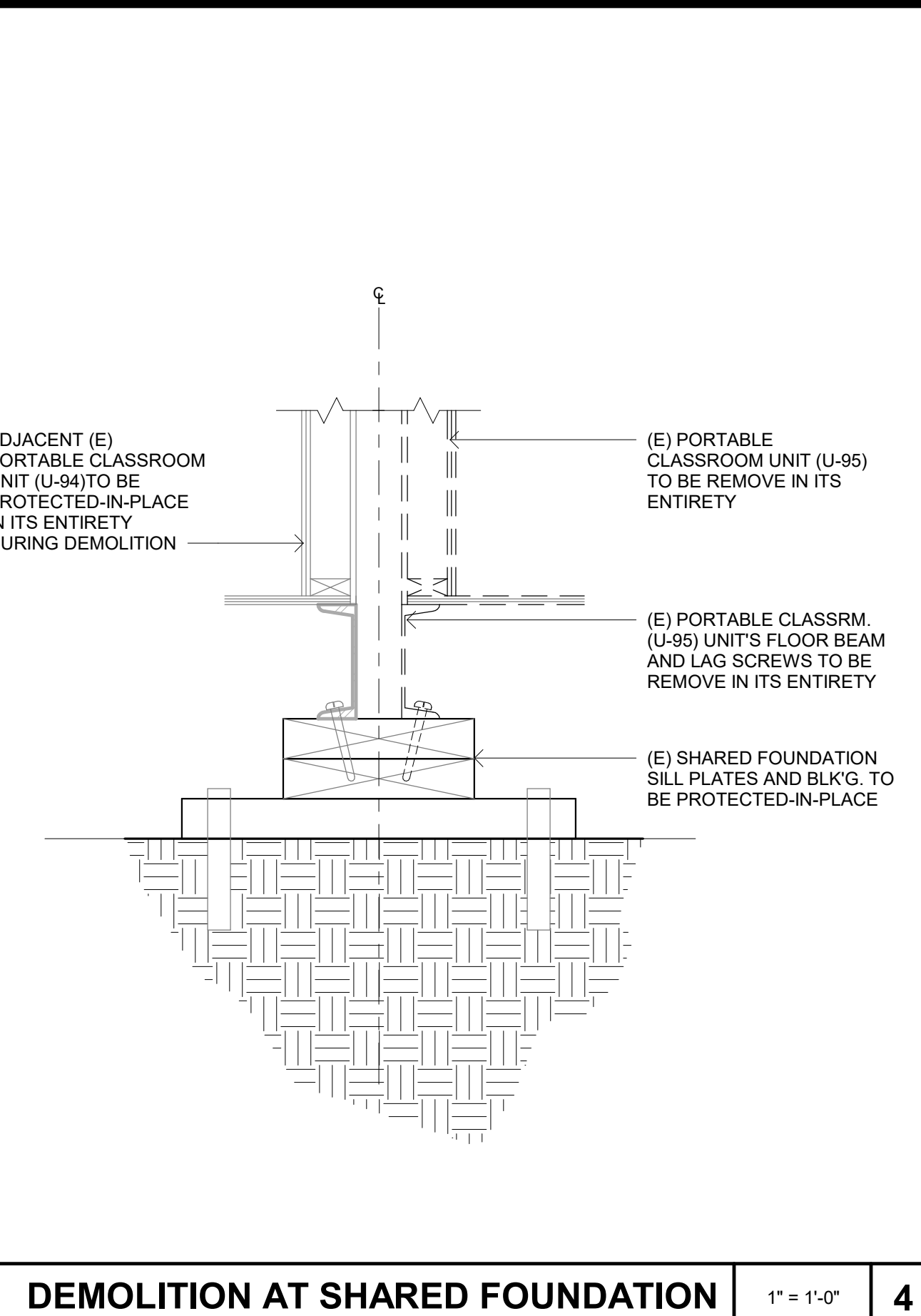

DEMOLITION AT SHARED FOUNDATION 1" = 1'-0" 4

- | # | DESCRIPTION |
|-----|-----------------------------------------------------------------------------------------------------------------------------------------------------------------------------------------------------------------------------------------------------------------------------------|
| 001 | REMOVE EXISTING PORTABLE CLASSROOM IN ITS ENTIRETY - CAP-OFF ONLY THE UTILITIES SERVING THE INDIVIDUAL UNIT AND SALVAGE, PROTECT-IN-PLACE AND/OR RE-ROUTE THE UTILITIES SERVING OTHER PORTABLE UNITS. U.N.O. |
| 002 | EXISTING FLOOR MOUNTED STEEL PIPE GUARDRAIL TO BE REMOVED IN ITS ENTIRETY |
| 003 | EXISTING FLOOR MOUNTED DOUBLE CHECK DETECTOR ASSEMBLY TO BE REMOVE IN ITS ENTIRETY |
| 006 | VERIFY EXISTING FIELD CONDITIONS PRIOR TO CUTTING-OUT OPNGS. ON THE WALL FOR PLUMBING AND ELECTRICAL CONNECTIONS FROM PORTABLE RESTROOMS (E) INFRASTRUCTURE - REFER TO IMPRVTS. PLAN FOR RELOCATION OF EXISTING DRINKING FOUNTAIN |
| 010 | EXISTING FREE-STANDING WATER CONNECTION PIPE TO BE REMOVED AND RELOCATED AT A NEW LOCATION IN A NEW UNDERGROUND YARD BOX - PROVIDE SHUT-OFF VALVE FOR FUTURE CONNECTION IN (N) YARD BOX |
| 011 | EXISTING WALL MOUNTED DOWNSPOUT TO BE REMOVED IN ITS ENTIRETY. REUSE AND RELOCATED - REFER TO IMPRVTS. PLANS AND ELEV. FOR RELOCATION OF EXISTING DOWNSPOUT |
| 012 | EXISTING DRINKING FOUNTAIN HANDRAIL AND BASE PLATE TO BE REMOVED, SALVAGED AND REUSED - REFER TO IMPRVTS. PLANS AND ELEV. FOR RELOCATION |
| 013 | EXISTING WALL-MOUNTED HI-LOW DRINKING FOUNTAIN AND ITS STAINLESS STEEL BACK PANEL TO BE REMOVED CAREFULLY, SALVAGED AND RELOCATED IN PHASE 1 - REFER TO IMPRVTS. PLANS AND ELEV. FOR RELOCATION |
| 014 | EXISTING WALL-MOUNT COMMUNICATION BOX PANEL TO REMAIN, SALVAGED, REUSED AND BE PROTECTED-IN-PLACE. PRIOR TO COMMENCING ANY WORK, BUILD AND PROVIDE A TEMPORARY ENCLOSURE TO STABILIZE AND ANCHOR THE (E) BOX PANEL. SEE DETAIL 6/A11.2 |
| 015 | EXISTING GUTTER AND DOWNSPOUT FROM ADJACENT PORTABLE CLASSROOM U-94 TO REMAIN AND BE PROTECTED AS REQ'D. SO THAT IT CAN BE REROUTED - SEE IMPRVTS PLAN FOR NEW RELOCATION OF DRAINAGE OUTLET |
| 016 | VERIFY EXISTING BOX PANEL AND ITS FIELD CONDITIONS TO DETERMINE WHETHER IT NEEDS TO REMAIN, SALVAGED, AND BE PROTECTED-IN-PLACE OR CAPPED-OFF. IF IT IS TO REMAIN PRIOR TO COMMENCING ANY WORK, BUILD AND PROVIDE A TEMPORARY ENCLOSURE TO STABILIZE AND ANCHOR THE (E) BOX PANEL |
| 020 | EXISTING EXTERIOR WALL MOUNTED LIGHT FIXTURE TO BE SALVAGED IN ITS ENTIRETY AND HANDED OVER TO THE DISTRICT |
| 022 | EXISTING WALL MOUNTED DOWNSPOUT AND GUTTER TO BE REMOVED IN ITS ENTIRETY, SALVAGED AND HANDED OVER TO THE DISTRICT |
| 024 | EXISTING STEEL PIPE GUARDRAIL WITH CABLE RAILING TO REMAIN AND BE PROTECTED-IN-PLACE |
| 026 | EXISTING CHAINLINK DOUBLE-GATE AND END POST TO REMAIN AND BE PROTECTED-IN-PLACE |
| 027 | EXISTING STEEL PIPE GUARDRAIL TO REMAIN AND BE PROTECTED-IN-PLACE |
| 030 | PROTECT IN-PLACE EXISTING ADJACENT PORTABLE CLASSROOM UNIT IN ITS ENTIRETY AT ALL TIMES DURING DEMOLITION AND CONSTRUCTION |
| 031 | PROTECT IN-PLACE EXISTING RESTROOM BLDG. AT ALL TIMES DURING DEMO. AND CONSTRUCTION. U.N.O. - REFER TO IMPRVTS. PLANS AND ELEV. FOR IMPRVTS. AND NEW REQ'D. CONNECTIONS |
| 037 | PROTECT-IN-PLACE EXISTING TEMP. 3/4" LIQUID TIGHT FIRE ALARM CONDUIT LINE BEING ROUTED FROM BELOW GRADE TO PORTABLE UNIT U-94 PRIOR TO DEMOLITION WORK AND AT ALL TIMES DURING DEMOLITION AND CONSTRUCTION OF IMPVT'S. |

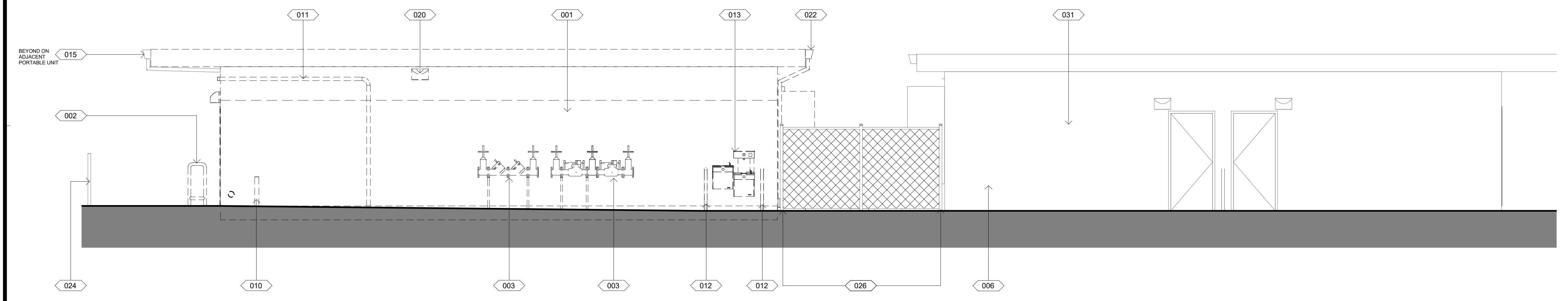

DEMOLITION SITE SECTION - EAST 1/4" = 1'-0" 3

DEMOLITION KEYNOTES

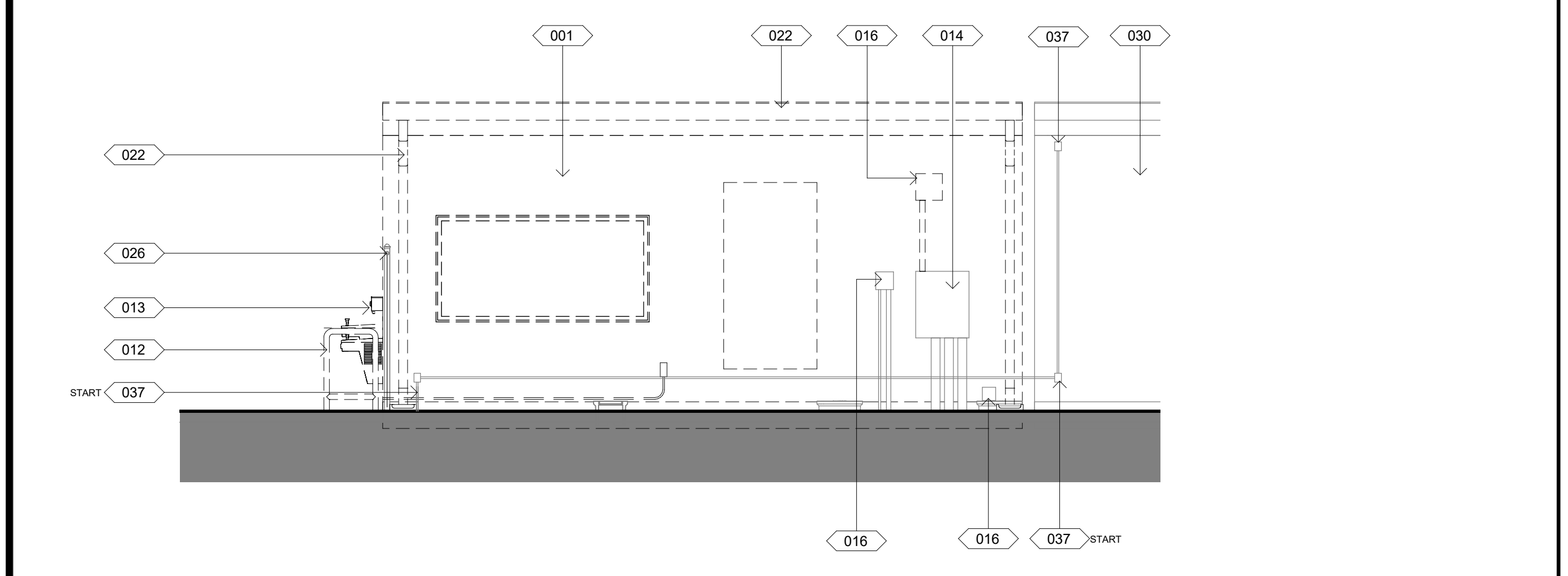

DEMOLITION SITE SECTION - NORTH 1/4" = 1'-0" 2

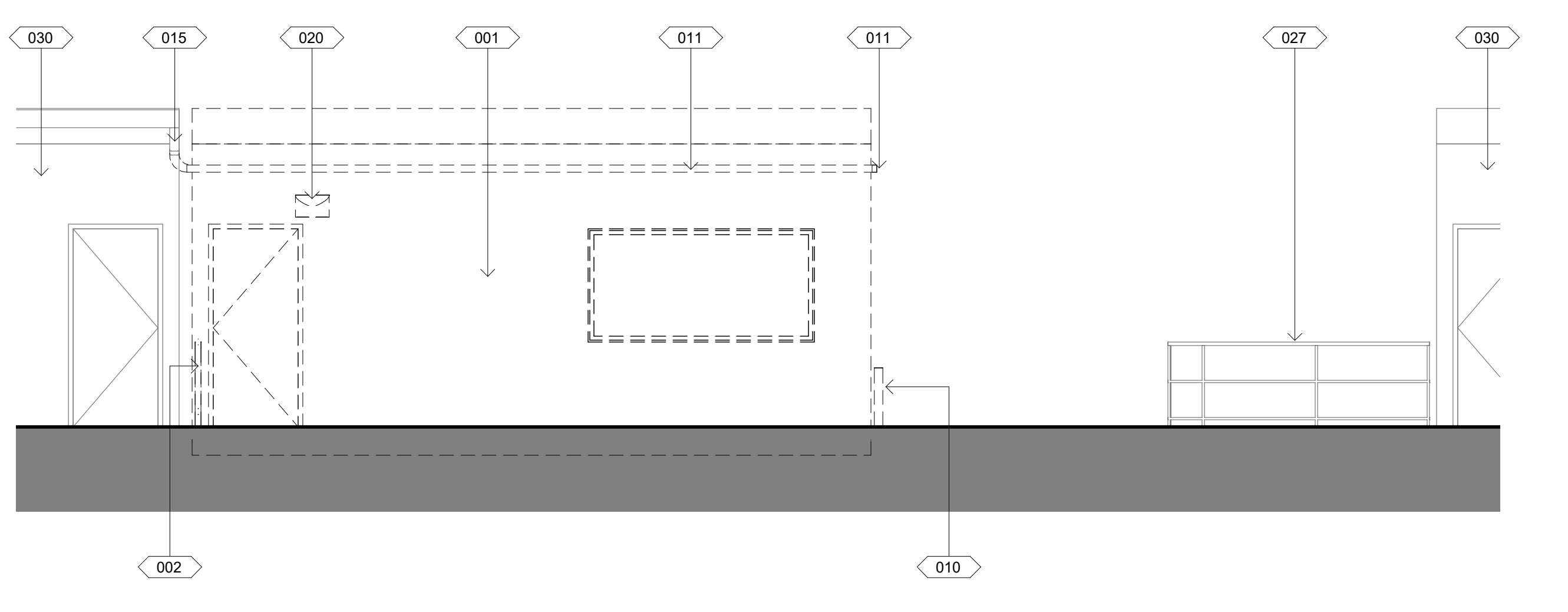

DEMOLITION SITE SECTION - SOUTH 1/4" = 1'-0" 1

OWNER: RANCHO SANTIAGO COMMUNITY COLLEGE DISTRICT

PROJECT NAME: SANTIAGO CANYON COLLEGE PORTABLE CLASSROOM (U-95) DEMOLITION 100% CONSTRUCTION DOCUMENTS

PROJECT ADDRESS: 8045 E. Chapman Avenue, Orange, CA 92869



REVISIONS:

NO.	DESCRIPTION	DATE

SET: 100% CD - 10/04/2021

PROJECT NO: 2021-40121

SCALE: As indicated

SHEET NUMBER: **A10.2**

SHEET TITLE:

DEMOLITION - BLDG. ELEVATIONS



THIS DOCUMENT CONTAINS INFORMATION PROPRIETARY TO SVA ARCHITECTS INC. AND IS FURNISHED IN CONFIDENCE FOR THE LIMITED PURPOSE OF EVALUATION, REVIEW OR REVIEW. THIS DOCUMENT OR ITS CONTENTS MAY NOT BE USED FOR ANY OTHER PURPOSE AND MAY NOT BE REPRODUCED OR DISCLOSED TO OTHERS WITHOUT THE PRIOR WRITTEN CONSENT OF SVA ARCHITECTS INC. ALL RIGHTS RESERVED. © COPYRIGHT 2019.

NOTES:
 1. PROVIDE DUST CONTROL AS REQ'D. DURING DEMOLITION & ASPHALT PAVEMENT COMPACTION AND INSTALLATION TYP. U.N.O.

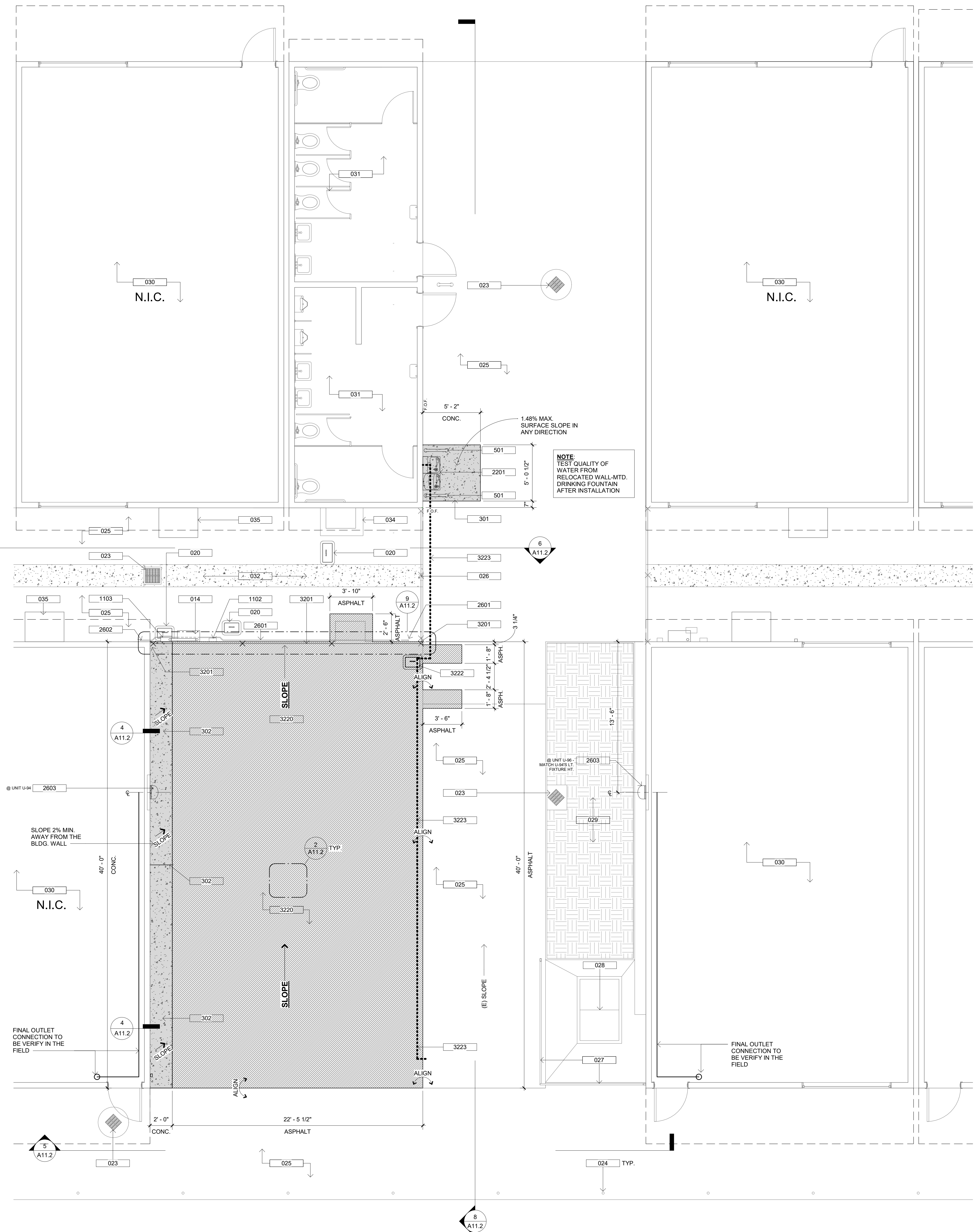

?	DESCRIPTION
014	EXISTING WALL-MOUNT COMMUNICATION BOX PANEL TO REMAIN, SALVAGED, REUSED AND BE PROTECTED-IN-PLACE. PRIOR TO COMMENCING ANY WORK, BUILD AND PROVIDE A TEMPORARY ENCLOSURE TO STABILIZE AND ANCHOR THE (E) BOX PANEL. SEE DETAIL 6/A11.2
020	EXISTING EXTERIOR WALL MOUNTED LIGHT FIXTURE TO BE SALVAGED IN ITS ENTIRETY AND HANDED OVER TO THE DISTRICT
023	EXISTING SITE CATCH BASIN TO REMAIN AND BE PROTECTED-IN-PLACE. PROVIDE INLET PROTECTION DURING THE DEMOLITION AND SITE CONSTRUCTION
024	EXISTING STEEL PIPE GUARDRAIL WITH CABLE RAILING TO REMAIN AND BE PROTECTED-IN-PLACE
025	EXISTING ASPHALT PAVEMENT TO REMAIN AND BE PROTECTED-IN-PLACE, AS INDICATED
026	EXISTING CHAINLINK DOUBLE-GATE AND END POST TO REMAIN AND BE PROTECTED-IN-PLACE
027	EXISTING STEEL PIPE GUARDRAIL TO REMAIN AND BE PROTECTED-IN-PLACE
028	PROTECT-IN-PLACE EXISTING COMMUNICATION VAULT
029	EXISTING LAWN AREA TO REMAIN
030	PROTECT IN-PLACE EXISTING ADJACENT PORTABLE CLASSROOM UNIT IN ITS ENTIRETY AT ALL TIMES DURING DEMOLITION AND CONSTRUCTION
031	PROTECT IN-PLACE EXISTING RESTROOM BLDG. AT ALL TIMES DURING DEMO. AND CONSTRUCTION, U.N.O. - REFER TO IMPRVTS. PLANS AND ELEV. FOR IMPRVTS. AND NEW REQ'D. CONNECTIONS
032	EXISTING CONCRETE V-GUTTER TO REMAIN AND BE PROTECTED-IN-PLACE AT ALL TIMES DURING DEMOLITION AND CONSTRUCTION
034	EXISTING C.M.U. STEM WALL OPNG. TO REMAIN AND BE PROTECTED-IN-PLACE
035	PROTECT-IN-PLACE ALL EXTERIOR WALL-MOUNT MECHANICAL AND ELECTRICAL EQUIPMENT FROM OTHER ADJACENT PORTABLE CLASSROOMS NOT IN SCOPE. TYP.
301	NEW 4-IN. POURED-IN-PLACE CONCRETE SLAB / PAD TO ANCHOR DRINKING FOUNTAIN STEEL PIPE HANDRAIL - MEDIUM BROOM FINISH SURFACE. REFER TO DETAIL #3 / A11.2
302	NEW CONCRETE CURB ALONG ENTIRE SIDE WALL OF ADJACENT (E) ADJACENT PORTABLE CLASSROOM UNIT'S FOUNDATION. SLOPE AWAY FROM BUILDING - MEDIUM BROOM FINISH SURFACE. REFER TO DETAIL #4 / A11.2. PROVIDE EXPANSION JOINT AT 20-FT. O.C.
501	RELOCATION OF EXISTING STEEL PIPE HANDRAIL AND ITS STL. FLR. PLATE ON EACH SIDE OF DRINKING FOUNTAIN - SECURE TO FLOOR W/ FOUR (4) 3/8" DIAM. FLUSH CONC. ANCHORS AT EACH PLATE
1102	VERIFY EXISTING BOX PANEL AND ITS FIELD CONDITIONS AND CONFIRM WHETHER IT NEEDS TO REMAIN OR CAPPED-OFF. IF IT IS TO REMAIN MOUNT W/ A UNITSTRUT CONNECTION OR SUPPORT BRACES ONTO NEW CHAINLINK FENCING OR POSTS
1103	VERIFY FIELD CONDITIONS AND CONFIRM WHETHER EXISTING BOX PANEL IS TO REMAIN. IF IT IS TO REMAIN, RELOCATE AND MOUNT TO NEW CHAINLINK FENCING OR POSTS W/ A UNISTRUT CONNECTION OR SUPPORT BRACES
2201	RELOCATION OF EXISTING WALL-MOUNTED HI-LOW DRINKING FOUNTAIN IN PHASE 1 - PROVIDE AND CONNECT WATER LINE AND ELECTRICAL POWER SOURCE
2601	PROTECT-IN-PLACE AT ALL TIMES DURING DEMOLITION AND CONSTRUCTION THE EXISTING TEMP. 3/4" LIQUID TIGHT FIRE ALARM HORIZONTAL LINE RUNNING FROM BELOW GROUND AND ROUTING AROUND (E) UTILITY CONDUITS / BOXES TOWARDS (E) UNIT U-94 - MOUNT/ANCHOR AND SECURE (E) HORIZONTAL CONDUIT TO NEW CHAINLINK FENCE AND POST
2602	PROTECT-IN-PLACE AT ALL TIMES DURING DEMOLITION AND CONSTRUCTION THE EXISTING TEMP. 3/4" LIQUID TIGHT FIRE ALARM CONDUIT RUNNING VERTICALLY ALONG (E) UNIT U-94 EXTERIOR WALL
2603	RELOCATE SALVAGED (E) WALL MOUNTED LIGHT FIXTURE, AS INDICATED - CONTRACTOR TO PROVIDE PHOTOMETRICS OF RELOCATED LIGHT FIXTURES TO VERIFY ACCEPTABLE FOOTCANDLE LEVELS AT PATH OF TRAVEL
3201	(N) 6-FOOT HIGH CHAIN LINK FENCE - TO MATCH EXISTING AND ADJACENT CHAIN LINK FENCE TYPE. SECURE AND TIE INTO EXISTING CHAIN LINK END POST OR ADJACENT PORTABLE UNIT CORNER POST W/ STL. HORIZ. MEMBERS. POTHOLE FOR ANY (E) UTILITY LINES PRIOR TO EXCAVATING AND FORMING POST FOOTINGS
3220	REGRADE AND RESURFACE W/ 4-IN. ASPHALT PAVEMENT O/ SCARIFY AND RECOMPACTED NATIVE SOIL (90% COMPACTION), AS INDICATED - REFER TO DETAIL #2 / A11.2. MATCH EXISTING ADJACENT SLOPE STORMWATER INTO EXISTING CONCRETE V-GUTTER. VERIFY FIELD CONDITIONS PRIOR TO COMMENCING WORK. TYP.
3222	INSTALL NEW WATER UTILITY YARD BOX AND RELOCATE WATER CONNECTION W/ SHUT-OFF VALVE
3223	INSTALL AND RUN NEW PVC WATER SUPPLY LINE BELOW GRADE FROM NEW WATER UTILITY YARD BOX TO NEW LOCATION OF EXISTING WALL-MOUNTED HI-LOW DRINKING FOUNTAIN AND PROVIDE CONCRETE THRUST BLOCK

OWNER: RANCHO SANTIAGO COMMUNITY COLLEGE DISTRICT
PROJECT NAME: SANTIAGO CANYON COLLEGE PORTABLE CLASSROOM (U-95) DEMOLITION 100% CONSTRUCTION DOCUMENTS
PROJECT ADDRESS: 8045 E. Chapman Avenue, Orange, CA 92869



REVISIONS:

NO.	DESCRIPTION	DATE

SET: 100% CD - 10/04/2021
PROJECT NO: 2021-40121
SCALE: As indicated

SHEET NUMBER: A11.1
SHEET TITLE:

IMPROVEMENT - LEVEL 1 FLOOR PLAN

KEYNOTES

	EXISTING ASPHALT PAVEMENT TO REMAIN
	EXISTING CONCRETE PAVEMENT TO REMAIN
	EXISTING LAWN AREA TO REMAIN
	NEW PORTLAND CEMENT CONCRETE PAVEMENT O/ COMPACTED NATIVE MATERIAL (90% COMPACTION) - REFER TO DETAIL #3 / A11.2
	NEW 4-IN. A.C. PAVEMENT O/ SCARIFY AND RECOMPACTED NATIVE SOIL (90% COMPACTION) - REFER TO DETAIL #2 / A11.2



THIS DOCUMENT CONTAINS INFORMATION PROPRIETARY TO SVA ARCHITECTS INC. AND IS FURNISHED IN CONFIDENCE FOR THE LIMITED PURPOSE OF EVALUATION, REVIEW OR REVIEW. THIS DOCUMENT OR ITS CONTENTS MAY NOT BE USED FOR ANY OTHER PURPOSE AND MAY NOT BE REPRODUCED OR DISCLOSED TO OTHERS WITHOUT THE PRIOR WRITTEN CONSENT OF SVA ARCHITECTS INC. ALL RIGHTS RESERVED. © COPYRIGHT 2019.

NOTES:
 1. COORDINATE W/ THE DISTRICT FOR FIBER REPAIR TECHNICIANS TO BE ONSITE DURING THE IMPROVEMENT PHASE AS A PRECAUTIONARY MEASURE IN THE EVENT THAT THE LINES OR FIBER JUNCTION BOX BECOME DAMAGED.

- LEGEND:**
- EXISTING NETWORK WIRING / CABLES BELOW GRADE TO BE PROTECTED-IN-PLACE DURING CONST. IMPVTS.
 - - - (N) ROUTE OF NETWORK WIRING / CABLES RE-ROUTED BELOW GRADE FROM BOX PANEL INTO UNIT U-94
 - (E) WALL MOUNTED COMMUNICATION PANEL FEEDING SEVERAL OF THE ADJACENT CLASSROOM UNITS - MOUNT ONTO (N) CHAINLINK FENCING W/ A UNISTRUT
 - EXISTING PVC PIPE W/ FIRE ALARM CABLES BELOW GRADE TO REMAIN
 - (N) WATER SUPPLY LINE BELOW GRADE TO BE PROTECTED-IN-PLACE

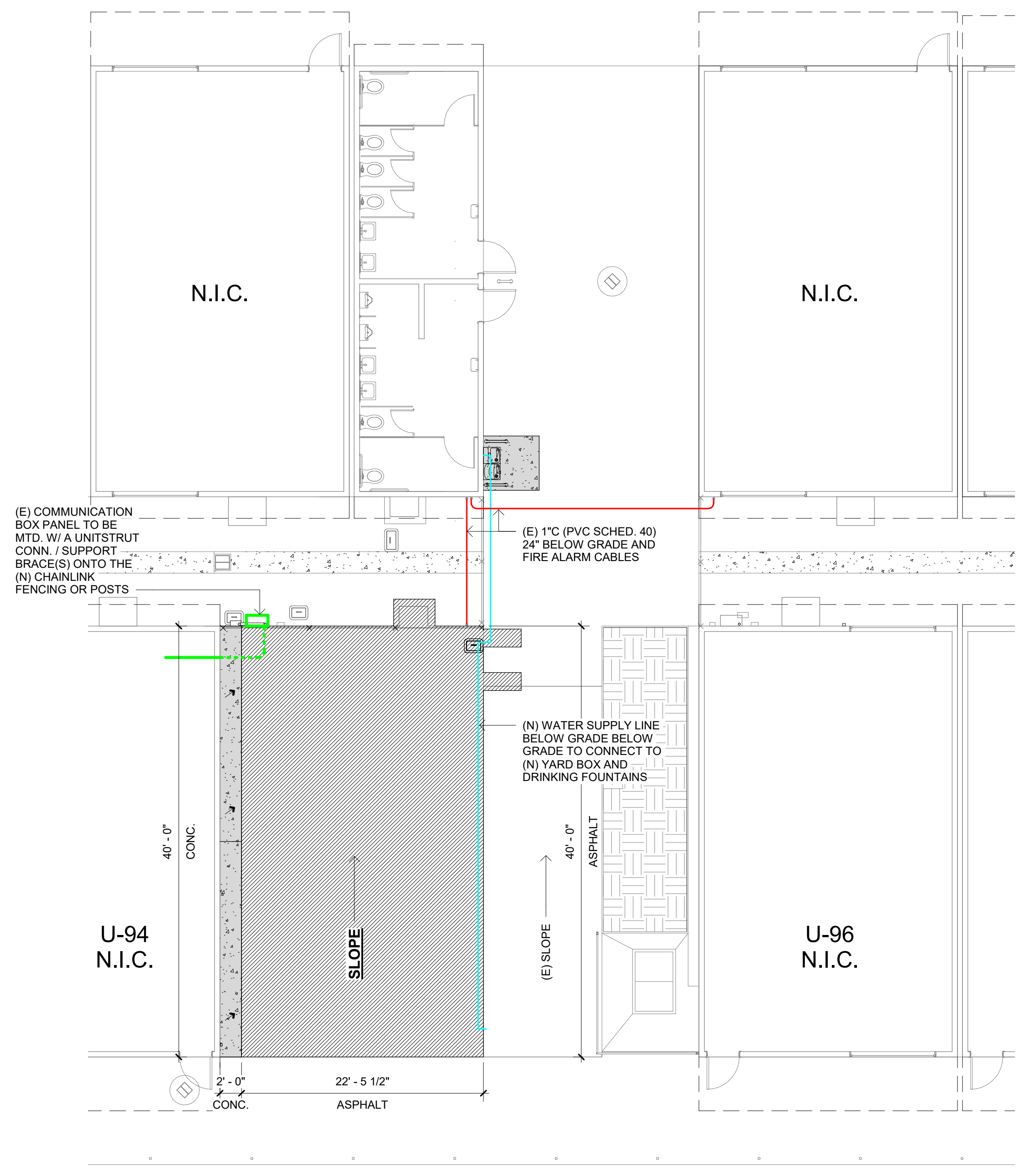

DIAGRAM - IT NETWORK IMPROVEMENT PLAN 1/8" = 1'-0" 2

NOTES:
 1. PRIOR TO DEMOLITION, CONTRACTOR TO COORDINATE W/ DISTRICT IT SUPPORT SERVICES DEPT. THE LOGISTICS OF THE EXISTING IT NETWORK LINES, PLAIN OLD TELEPHONE SERVICE (P.O.T.S.) LINES, JUNCTION BOXES, ANYTHING NETWORK RELATED DURING DEMOLITION AND THE IMPROVEMENT PHASE.
 2. VERIFY FIELD CONDITIONS W/ DISTRICT IT SUPPORT SERVICES DEPT. TO AVOID CUTTING OR DISCONNECTING ANY OF THE UNDERGROUND FIBER LINES DURING THE DEMOLITION AND/OR THE IMPROVEMENTS.
 3. CONTRACTOR TO COORDINATE W/ THE DISTRICT FOR PROVISIONS FOR FIBER REPAIR TECHNICIANS TO BE ONSITE DURING THE DEMOLITION EFFORTS AS A PRECAUTIONARY MEASURE IN THE EVENT THAT THE LINES BECOME DAMAGED.

- LEGEND:**
- EXISTING NETWORK WIRING / CABLES BELOW GRADE TO BE PROTECTED-IN-PLACE DURING DEMOLITION
 - - - EXISTING NETWORK WIRING / CABLES BELOW GRADE TO BE RE-ROUTED AND DEMOLISH
 - (E) WALL MOUNTED COMMUNICATION PANEL FEEDING SEVERAL OF THE ADJACENT CLASSROOM UNITS

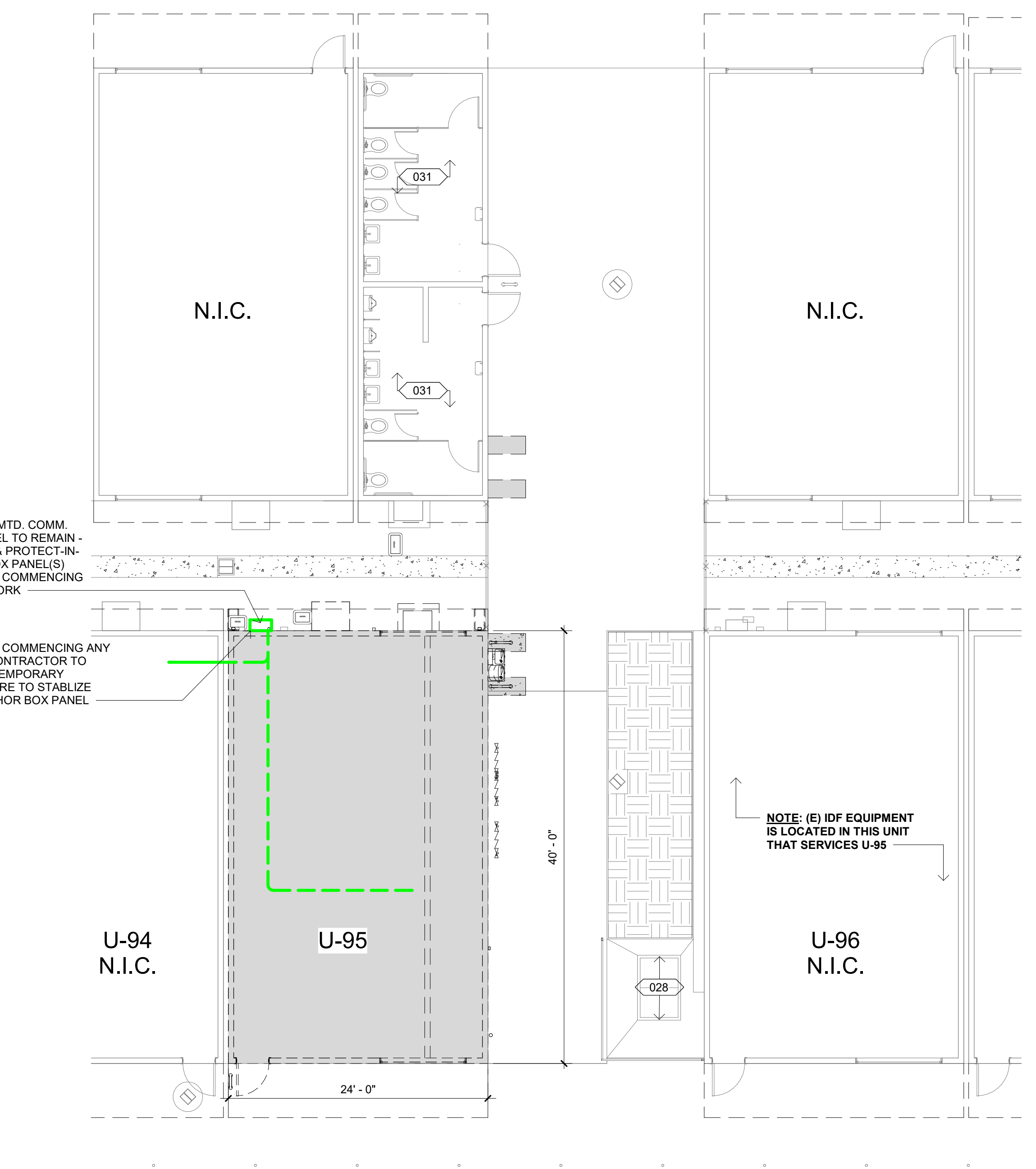

DIAGRAM - IT NETWORK RE-ROUTING PRIOR TO DEMOLITION PLAN 1/8" = 1'-0" 1

OWNER: RANCHO SANTIAGO COMMUNITY COLLEGE DISTRICT
 PROJECT NAME: SANTIAGO CANYON COLLEGE PORTABLE CLASSROOM (U-95) DEMOLITION 100% CONSTRUCTION DOCUMENTS
 PROJECT ADDRESS: 8045 E. Chapman Avenue, Orange, CA 92869



REVISIONS:

NO.	DESCRIPTION	DATE

SET: 100% CD - 10/04/2021
 PROJECT NO: 2021-40121
 SCALE: 1/8" = 1'-0"

SHEET NUMBER: **A11.3**
 SHEET TITLE:

IT NETWORK PRE-DEMOLITION AND IMPVT. DIAGRAMS



THIS DOCUMENT CONTAINS INFORMATION PROPRIETARY TO SVA ARCHITECTS INC. AND IS FURNISHED IN CONFIDENCE FOR THE LIMITED PURPOSE OF EVALUATION, DESIGN OR REVIEW. THIS DOCUMENT OR ITS CONTENTS MAY NOT BE USED FOR ANY OTHER PURPOSE AND MAY NOT BE REPRODUCED OR DISCLOSED TO OTHERS WITHOUT THE PRIOR WRITTEN CONSENT OF SVA ARCHITECTS INC. ALL RIGHTS RESERVED. © COPYRIGHT 2019.