

RANCHO SANTIAGO COMMUNITY COLLEGE DISTRICT



ADDENDUM NO. 01

**Bid #1472 Campus Entrance Improvements Phase 2
at
Santiago Canyon College**

Address: 8045 East Chapman Avenue, Orange, CA 92869

Project ID #3742, DSA #04-122457

March 13, 2025

**Owner:
Rancho Santiago Community College District
2323 North Broadway, Room 112
Santa Ana, California 92706**

**RECEIPT OF THIS ADDENDUM MUST BE ACKNOWLEDGED ON BID FORM WHEN
SUBMITTED**

The following changes, additions, deletions or corrections shall become a part of the Contract Documents for the project named on the previous page and all other conditions shall remain the same. The Bidders shall be responsible for transmitting this information to all affected Subcontractors and Suppliers, prior to the closing of Bids. Prospective Bidders shall acknowledge receipt of all Addenda in the space provided on the Bid Proposal Form by the number (list every addenda). Failure to do so shall deem the Bid Proposal as non-responsive and subject the Bidder to disqualification.

Item No. AD 1-1 Bid Documents – Part 2 (Procurement and Contracting Provisions)

- Revised “General and Supplementary Conditions”, Part 2 Procurement and Contracting Provisions: Sections 4.11, 5.5, 9.8, 13.10, 43, 18.1.2.2, Subsection E, Supplementary Conditions.

Item No. AD 1-2 Responses to Questions

The following provides a response to the Bidder’s Request for Pre-Bid Information submitted on the Pre-Bid Clarification Form. See attached for a total of (nineteen) RFI Response(s).

Enclosure: Revised Procurement and General Conditions Part 2
 (19) Pre-Bid Clarification Forms

This is the end of Addendum No.01

Safety, Access Compliance or Fire and Life Safety that will not require a DSA approval (except to confirm that no Approval is required). See Article 17.

- 4.10 Construction or Construction Services means all labor and services necessary for the construction of the Project, and all materials, equipment, tools, supplies and incidentals incorporated or to be incorporated in such construction as fully described in the Contract Documents.
- 4.11 Construction Costs means any and all costs incurred by the Contractor with respect to the construction and equipping, as the case may be, of the Project, whether paid or incurred prior to or after the date hereof, including, without limitation, costs for Site preparation, the removal or demolition of existing structures, the construction of the Project and related facilities and improvements, and all other work in connection therewith, security of the Site and Project, Contractors' overhead and supervision at the Project site, all costs and expenses including any taxes or insurance premiums paid by the Contractor with respect to the Property, and administrative and other expenses necessary or incident to the Project, excluding Contractor's home office overhead and field office overhead (which both shall be part of the Contractor's General Conditions) and Contractor's profit and fee. The term "Construction Costs" includes all Contractor's costs associated with preparing or generating additional copies of any Contract Documents, as defined below, related to or required for the Project, including preparation or generation of additional plans and specifications for Contractor's subcontractors. In no event shall Construction Costs exceed the Bid Proposal. **The Contractor shall order and obtain materials and equipment sufficiently in advance of its Work at no additional cost or advance payment from District to ensure against price escalations or delays. All materials and equipment shall be stored on-Site and secured by Contractor unless otherwise approved in writing by the District.**
- 4.12 Construction Manager or CM means the individual, partnership, corporation, joint venture, or any combination thereof, or its authorized representative, named as such by the District. If there is a Construction Manager, they may assist in various aspects of the Project including, but not limited to monitoring the progress of the construction, reviewing and monitoring the schedule, progress of work, monitoring pay requests, facilitating communications, advising the District and its Board of Trustees on various aspects of the construction and Project related processes. If no Construction Manager is used on the Project that is the subject of this Contract, then all references to Construction Manager herein shall be read to refer to District.
- 4.13 Contract Documents (Sometimes referred to as Construction Documents) consist of the Construction Services Agreement between the District and the Contractor (hereinafter the Contract or Agreement), Conditions of the Contract (General, Supplementary and other Conditions), Drawings, Specifications, Addenda issued prior to bid, instructions to bidders, notice to bidders, and the requirements contained in the Bid Documents, other documents listed in the Contract, and Modifications issued after execution of the Contract. A Modification is a written amendment to the Contract signed by parties, a Change Order, a Construction Change Document, or a written order for a minor change in the Work issued by the Architect. The Contract Documents collectively form the entire and integrated agreement between the parties hereto and supersedes prior negotiations, representations, or agreements, either written or oral. The Contract may be amended or modified only by a written Modification. The Contract Documents shall not be construed to create a contractual relationship of any kind between the Architect and Contractor, between the District and any Subcontractor or Sub-subcontractor, or between any persons or entities other than the District and the Contractor. The Architect shall,

1

5.3.2 *Notice After Pre-Construction Review.* If, as a result of this review, the Contractor perceives: i) any error, inconsistency, conflict, ambiguity, omission, or lack of sufficient detail or explanation in the Drawings, Specifications or other Contract Documents; or ii) that any of the Drawings, Specifications or other Contract Documents do not conform in all respects with all laws, ordinances, codes, rules, regulations and other governmental requirements applicable to the Work; then, prior to commencing any portion of the Work, affected or implicated by Contractor's review, the Contractor shall prepare and submit a Request(s) for Information (RFI) to the District and Architect. The Architect will issue an RFI Response and, if required, a Construction Change Directive or other written directive to the Contractor setting forth a correction or clarification of the matters specified in the RFI.

5.4 Ongoing Review of Contract Documents. The Contractor shall maintain on an ongoing basis such knowledge and understanding of the Contract Documents as necessary for full and timely compliance therewith. At any time during the course of the Work, if the Contractor perceives any error, inconsistency, conflict, ambiguity, omission, or lack of sufficient detail or explanation in the Drawings, Specifications or other Contract Documents, or any non-conformance of the Drawings, Specifications or other Contract Documents with all laws, ordinances, codes, rules, regulations and other governmental requirements applicable to the Work, then the Contractor shall submit an RFI to the District and Architect. The Contractor shall submit such RFI promptly after discovering any discrepancy with the Contract Documents, so that the matter may be addressed without any resulting delay in the Work or Work by Others. Within a reasonable time after receipt of an RFI, and to the extent necessary and appropriate, the Architect will issue a response to the RFI to the Contractor. The response may be in the form of a Construction Change Directive Category A or B or other written directive to the Contractor setting forth a correction or clarification of the matters specified in the notice.

5.5 Price Fluctuations. As part of Contractor's due diligence responsibilities, Contractor is required to order, obtain, and store materials and equipment sufficiently in advance of its Work at no additional cost or advance payment from District to assure that there will be no delays. Contractor understands that this is a multi-year contract and that materials fluctuate in value and shall have adequately addressed market fluctuations through agreements with Contractor Vendors or by other means. Contractor further understands and incorporates into Contractor's bid cost any wage rate increases during the Project for the Contractor's labor force as well as all other subcontractor and vendor labor forces. Contractor also understands the length of the Project schedule and has incorporated an appropriate budget to include labor, material, and equipment escalation costs into the Bid Proposal. At no time will the District accept any costs associated with these increases. District shall not be responsible for market fluctuations in costs or labor rate increases during the Project. Contractor further has incorporated any and all cost increases in areas of Work where there may be schedule variations so that cost increases are not passed through to the District.



5.5.1 If Contractor asserts a request for additional compensation due to a price fluctuation for escalation of materials costs, then this provision exclusively governs those request(s) by Contractor and the following are all conditions precedent to Contractor's submission of a Change Order Request or Claim for additional compensation for escalation of materials costs.

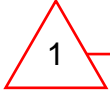

5.5.2 Contractor shall not be entitled to submit a request for compensation for escalation of materials unless the actual increase in the cost of the materials in question exceeds ten percent (10%) of the **total** material costs on the Project at the time of bid.

5.5.2.1 The cost escalation is the result of unusual and unforeseeable market conditions not reasonably foreseeable at the time of award of the Contract and was not an escalated cost resulting from any action or inaction of the Contractor.

5.5.2.2 Contractor timely ordered and/or purchased the materials at issue, based on (1) Contractor's constructive knowledge of the supply chain for required materials and (2) Contractor's request to utilize the provisions in the Contract Documents related to the District's payment for materials and equipment purchased and stored on Site or offsite.

5.5.2.2.1 Contractor's material costs were reasonable at the time of Contractor's bid for the Project.

5.5.2.2.2 Contractor demonstrates an actual increase in the cost of materials in its Contract Price at the time of award of the Contract and/or as reflected in Contractor's escrowed bid documents compared to Contractor's actual material payment cost paid either at time of purchase or delivery, whichever is earlier.

5.5.2.2.3 An actual year-to-date price increase has occurred and can be substantiated by the E.N.R. 20-City Average Material Cost Index for the material at issue that demonstrates the claim for an increase in price of the material at the time of delivery of the higher priced material to the Project.

5.5.2.3 The writing shall be accompanied by all documents substantiating Contractor's position regarding the proposed change order.

5.5.2.4 A request for additional compensation for price escalation that asserts an effect on any schedule milestones and/or Contract Time shall include all pertinent scheduling data demonstrating the impact(s) on the critical path(s), milestone(s) and/or Contract Time.

5.5.2.5 Contractor agrees that it shall not base its damages, its calculations or its proposed change order on a "total cost" approach, a "modified total cost" approach or a "jury verdict method" approach.

5.5.3 **Certification.** Contractor's proposed change order shall be certified by a responsible officer of the Contractor in accordance with the requirements of the Contract Documents. This certification shall be under penalty of perjury and must include the following language immediately above or before the Contractor's signature: ***"I declare under penalty of perjury under the laws of the State of California that the information provided and statements made in this proposed change order are true and correct, substantiated and of merit."*** The Contractor acknowledges that this requirement is not a mere formality but is intended to ensure that the Contractor only submits proposed change orders that it believes are true and

correct, substantiated and have merit. Should Contractor fail to submit the foregoing written statement signed under penalty of perjury, Contractor waives and releases its request for a proposed change order or a Claim, including all rights and remedies in connection therewith. This certification must include a certification of any portion of the proposed change order from Subcontractor(s) or others who are asserting cost or time increases by and through Subcontractors and/or the Contractor.

6. SUBCONTRACTORS

- 6.1 DVBE. Participation in Disabled Veteran Business Enterprise (DVBE) contracting goals is required under the Contract Documents. In accordance with Education Code section 71028 the District has a DVBE participation goal of 3% per year of the overall dollar amount expended each year by the District. The Contractor shall make good faith efforts to achieve the DVBE participation goal under the Contract Documents. The Contractor must require bidding subcontractors to make a good faith effort to contact and utilize DVBE contractors and suppliers in securing bids for performance of the Project. Their efforts shall be documented on the DVBE Good Faith Effort Form attached to Construction Documents. Information regarding certified DVBE firms can be obtained from the Office of Small Business Certification and Resources (OSBCR) at (916) 323-5478 or (916) 322-5060 as well as the OSBCR website at www.dgs.ca.gov/osbcr. Verification of DVBE status must be obtained from the OSBCR by receiving an approved certification letter and reference number from that office. Contractor must retain documentation of its good faith efforts, in the event such documentation is requested by the District. Good faith efforts are demonstrated by evidence of the following: a) contact was made with the District regarding the identification of DVBEs; b) contact was made with other state agencies and with DVBE organizations to identify DVBEs; c) advertising was published in trade papers and papers focusing on DVBEs; d) invitations to bid were submitted to potential DVBE contractors; and e) available DVBEs were considered.
- 6.2 The Contractor shall provide the District with information for all Subcontracts as required in the Contractor's Submittals and Schedules Section.
- 6.3 No contractual relationship exists between the District and any Subcontractor, supplier, or Sub-subcontractor by reason of the Contract.
- 6.4 The Contractor agrees to bind every Subcontractor by terms of the Contract as far as those terms are applicable to Subcontractor's work. If the Contractor shall subcontract any part of the Contract, the Contractor shall be as fully responsible to the District for acts and omissions of any Subcontractor and of persons either directly or indirectly employed by any Subcontractor, as it is for acts and omissions of persons directly employed by the Contractor. The divisions or sections of the Specifications are not intended to control the Contractor in dividing the Work among Subcontractors or limit the work performed by any trade.
- 6.5 The District's consent to, or approval of, or failure to object to, any Subcontractor under the Contract shall not in any way relieve the Contractor of any obligations under the Contract and no such consent shall be deemed to waive any provisions of the Contract.
- 6.6 The Contractor is directed to familiarize themselves with sections 4100 through 4114 of the Public Contract Code of the State of California, as regards subletting and subcontracting, and to comply with all applicable requirements therein. In addition, the Contractor is directed to familiarize themselves with sections 1720 through 1861 of the Labor Code of the State of California, as regards the payment of prevailing wages and related issues, and to comply with all applicable requirements therein all including, without limitation, section 1775 and the

9.6 Commencement and Diligent Performance of Work. The Contractor must commence performance of the Work upon the issuance of notice(s) to proceed and, thereafter, must diligently perform all acts and cause to be done all other things necessary to complete the Project within the time period(s) specified in the Construction Schedule, including, without limitation: (i) performing all required Work; (ii) obtaining all required services; (iii) providing an adequate workforce at all times; and (iv) providing sufficient quantities of equipment, materials and supplies when needed. If the performance of the Work falls behind schedule, the Contractor must provide to the District and the Architect a proposed revision to the Construction Schedule that clearly specifies how the Contractor will bring the Work back into conformance with the time for completion required pursuant to the Contract Documents (“Recovery Schedule”). Each Recovery Schedule is subject to approval by the District. Upon approval of the Recovery Schedule, it shall be incorporated into a Revised Baseline Construction Schedule and the Contractor must, at its cost, accelerate and/or do all other things as necessary to complete the Project within the time specified in the revised Construction Schedule.

9.7 Time for Preparing Submittals Must Be Incorporated in Schedule: Contractor shall include Submittals as line items in the Construction Schedule. Time for preparing and coordinating Submittals shall not delay the Work, Milestones, or the Substantial Completion Date and the Final Completion Date and shall be in conformance with Article 15.

1

9.7.1 Failure to provide the submittals by the listed timelines will subject the Contractor to the assessment of Liquidated Damages for failure to meet the Contract timelines.

9.8 Force Majeure: A party shall be excused from the performance of any obligation imposed in the Contract Documents for **only for a period and only** to the extent that a party is prevented from performing such obligation, in whole or in part, as a result of **unforeseen** delays caused by **a governmental restriction , law, or other order by a governmental agency or governmental entity preventing performance of the Work,** ~~the other party or third parties, a governmental agency or entity,~~ an act of God, war, terrorism, civil disturbance, forces of nature, fire, flood, earthquake, strikes or lockouts. **Any such interference with the performance of the Work under this Article shall not be a default hereunder or a grounds for termination., and such nonperformance will not be a default hereunder or a grounds for termination.** Any delay associated with COVID-19, or any derivative or similar strain thereof, **or any governmentally declared pandemic or similar public pestilence declared by any** federal, state, or local order relating thereto, shall not be considered a Force Majeure event unless it renders Contractor’s performance impossible, and that event was not reasonably foreseeable at the time of the execution of the Contract.

10. INSPECTION OF WORK / PROJECT INSPECTOR AND ARCHITECT

10.1 Inspection of Work/Project Inspector. The District shall hire its own Division of State Architect Project Inspector as required by law. District, District’s Representatives, and the Division of the State Architect shall at all times have access to the work whether it is in preparation or progress, and Contractor shall provide proper facilities for such access and for inspection.

10.1.1 *General.* One or more project inspectors employed by the District and approved by the Division of the State Architect will be assigned to the Work in accordance with the requirements of Title 24 of the California Code of Regulations. The Project Inspector(s) duties are as specifically defined in Title 24 Section 4-333 and 4-342 and in DSA IR A-8.

13.10 Taxes. The Contractor's Contract Price shall include any and all applicable sales taxes or other taxes that may be due in accordance with section 7051 of the Revenue and Taxation Code; Regulation 1521 of the State Board of Equalization or any other tax code that may be applicable. The Contractor shall pay all applicable Federal, State, local taxes, and any other tax codes that may be applicable on all materials, labor, or services furnished by it, and all taxes arising out of its operations under the Contract Documents. The District is exempt from Federal Excise Tax, and a Certificate of Exemption shall be provided upon request.

13.11 Progress Reports. The Contractor shall record the progress of the Project, and shall submit monthly written progress reports to the District and the Architect including information on the entire Project, showing percentages of completion and the number and amounts of proposed Work Modifications and their effect on the Construction Costs as of the date of the report. The Contractor shall also keep a daily log containing a record of weather, Contractors, work on the site, number of workers, work accomplished, problems encountered, and other similar relevant data as the District may require. The Contractor shall make the log available to the District and the Architect. The District shall be promptly informed of all anticipated delays. In the event that the Contractor determines that a schedule modification is necessary, the Contractor shall promptly submit a revised Schedule for approval by the District

13.12 Schedule of Values.

13.12.1 *Break Down of Schedule of Values.* A detailed Schedule of Values shall be submitted, in accordance with the Contract Documents. The Schedule of Values shall be broken down by Project, site, building, milestone, or other meaningful method to measure the level of Project Completion as determined by the District. The Schedule of Values shall include, but not be limited, to General Conditions, the Subcontractor Costs, the costs for the Submittals, Punch Lists (maximum of 2% of total cost of the work), Commissioning and Start-Up, and Closeout Submittals/As-Built (minimum of 2% of total cost of the work).

13.12.2 *Based on Contractor Bid Costs.* The Schedule of Values shall be based on the costs from Contractor's bid to the District. However, the submission of the Schedule of Values shall not be front loaded so the Contractor is paid a greater value than the value of the Work actually performed and shall not shift funds from parts of the Project that are later to Work that is performed earlier.

13.12.3 *Largest Dollar Value for Each Line Item.* Identify subcontractors and materials suppliers proposed to provide portions of Work equal to or greater than ten thousand dollars (\$10,000) or one-half (1/2) of one percent (1%) of their Contract Price, whichever is less.

13.12.4 *Allowances.* Any Allowances provided for in the Contract shall be a line item in the Schedule of Values.

13.12.5 *Labor and Materials Shall Be Separate.* Labor and Materials shall be broken into two separate line items unless specifically agreed in writing by the District.

13.12.6 *District Approval Required.* The District shall review all submissions of Schedule of Values received pursuant to this Article 13 in a timely manner. All submissions must be approved by the District before becoming the basis of any payment, including increasing the "Largest Dollar Value for Each Line Item" herein above, at the District's discretion.

13.12.7 *General Conditions Daily Rate.* The daily rate shall be calculated by dividing the total general conditions fees by the total contract duration.

18.12.2 Contractor is not entitled to additional compensation for any delay, even a delay caused by Adverse Weather or an Excusable Delay, unless all of the following conditions are met:

- a. The District is responsible for the delay;
- b. The delay is unreasonable under the circumstances involved and impacts the critical path of the Work and extends the most current Contract Completion date;
- c. The delay was not within the contemplation of District and Contractor;
- d. Contractor complies with the Change Order procedures, and if necessary, the Claims procedures of the Contract Documents;
- e. The delay could not have been avoided or mitigated by the Contractor's care, prudence, foresight, and diligence;
- f. The delay extends the most current Contract Completion date; and
- g. The delay is not concurrent with a Contractor-caused delay or other type of Excusable Delay.

18.12.3 In accordance with California Public Contract Code section 7102, if the Contractor's progress is delayed by the events described in the preceding subsection, Contractor shall not be precluded from the recovery of damages directly and proximately resulting therefrom. In that event, Contractor's damages, if any, shall be limited to direct, actual and unavoidable additional costs of labor, materials or construction equipment directly resulting from that delay, and shall exclude special, indirect or consequential damages. In no event shall Contractor seek costs or damages for delays, interruptions, hindrances or disruptions to the Work for on-Site or off-Site costs or damages based upon formulas, e.g. Eichleay or other formula. Except as expressly provided for herein, Contractor shall not have any other claim, demand or right to adjustment of the Contract Price arising out of delay, interruption, hindrance or disruption to the progress of the Work. Adjustments to the Contract Price and the Contract Time, if any, on account of Changes to the Work or Suspension of the Work shall be governed by the applicable provisions of the Contract Documents, including without limitation, the "Work Modifications" section and the percentages in the "Format" subsection thereof.

18.12. Excusable and Non-Compensable Delay(s)

18.12.1. An "Excusable Delay" shall mean an interruption of the Work beyond the reasonable control of the Contractor and that:

- a. Could have not been avoided by the Contractor exercising care, prudence, foresight, and diligence, and
- b. Actually extended the most current Project Completion date.

18.12.2. Excusable Delays and claims for excusable delays from the performance of any obligation imposed in the Contract Documents shall only be for the period and only to the extent that a party is prevented from performing such obligation, in whole or in part, as a result of unforeseen delays caused by a governmental restriction, law, or other order by a

1

governmental agency or governmental entity preventing performance of the Work, an act of God, war, terrorism, civil disturbance, forces of nature, fire, flood, earthquake, strikes or lockouts. Any such interference with the performance of the Work under this Article shall not be a default hereunder or a grounds for termination. Any delay to the Work associated with COVID-19, or any derivative or similar strain thereof, or any governmentally declared pandemic or similar public pestilence declared by any federal, state, or local order relating thereto, shall not be considered a basis for an excusable delay Force Majeure event unless it renders Contractor's performance impossible, and that event was not reasonably foreseeable at the time of the execution of the Contract.

- 18.13. Contractor is aware that governmental agencies and utilities, including, without limitation, the Division of the State Architect, the Department of General Services, gas companies, electrical utility companies, water districts, and other agencies may have to approve Contractor-prepared drawings or approve a proposed installation. Contractor shall include in its bid, time for possible review of its drawings and for reasonable delays and damages that may be caused by such agencies. Contractor is not entitled to make a claim for damages or delays or an Excusable Delay arising from the review of Contractor's drawings or other approvals from the Division of the State Architect, the Department of General Services, gas companies, electrical utility companies, water districts, and other agencies.
- 18.14. Neither the financial resources of the Contractor or any person or entity directly or indirectly engaged by the Contractor in performance of any portion of the Work shall be deemed conditions beyond the control of the Contractor. If an event of Excusable Delay occurs, the Contract Time shall be subject to adjustment hereunder only if the Contractor establishes: (i) full compliance with all applicable provisions of the Contract Documents relative to the method, manner and time for Contractor's notice and request for adjustment of the Contract Time; (ii) that the event(s) forming the basis for Contractor's request to adjust the Contract Time are outside the reasonable control and without any fault or neglect of the Contractor or any person or entity directly or indirectly engaged by Contractor in performance of any portion of the Work; and (iii) that the event(s) forming the basis for Contractor's request to adjust the Contract Time directly and adversely impacted the critical path of the Work as indicated in the approved Construction Schedule or the most recent updated approved Construction Schedule relative to the date(s) of the claimed event(s) of Excusable Delay.
- 18.15. Computation of Time / Adverse Weather
- 18.15.1. The Contractor will only be allowed a time extension for Adverse Weather conditions if requested by Contractor within five (5) calendar days of the Adverse Weather event, and only if all of the following conditions are met – thereby making the resulting delay an Excusable Delay.
- a. The weather conditions constitute Adverse Weather, as defined herein and further specified in the Supplementary Conditions;
 - b. Contractor can verify that the Adverse Weather caused delays in excess of five (5) hours of the indicated labor required to complete the scheduled tasks of Work on the day affected by the Adverse Weather;
 - c. The Contractor's crew is dismissed as a result of the Adverse Weather; and
 - d. The number of days of delay for the month exceed those indicated in the Supplementary Conditions.

C. Article 26 - Hours of work:

Where a single shift is worked, eight (8) consecutive hours between 7:00AM and 4:00PM shall constitute a workday at the applicable prevailing wage rate(s).

**D. COVID-19 or Other Governmentally Declared Infectious Disease, Pestilence, or Virus
Related Provisions Applicable to Contractor's Work**

- 1) Contractor shall provide to the District, no later than ten (10) days after issuance of NTP, all protocols and procedures that will be in place during construction to ensure prevention the spread of coronavirus (SARS-CoV-2) **or other governmentally declared infectious disease, pestilence or virus**. Measures implemented shall at a minimum follow Cal OSHA's Safety and Health Guidance, COVID-19 Infection Prevention in Construction as well as implement the following:
 - a) At any time the Contractor receives notice that one of their employees tests positive for COVID-19 **(or any other governmentally declared infectious disease, pestilence or virus)** and/or an employee's family member tests positive, Contractor must immediately notify the District Representative.
 - b) Maintain a daily attendance log of all workers and visitors on site.
- 2) Contractor shall be responsible for obtaining and complying with any all COVID-19 **(or any other governmentally declared infectious disease, pestilence or virus)** construction protocols from federal, state, or local entities applicable to the Project.
- 3) Contractor's obligations to provide materials and equipment for the Project and the Project site shall include obtaining and providing personal protective equipment ("PPE") to its employees and that subcontractors to prevent the spread of COVID-19 **(or any other governmentally declared infectious disease, pestilence or virus)** or any other similar virus or derivative strain, as well providing adequate site sanitation facilities. The Contract Price includes all such costs.
- 4) Contractor's site safety obligations require Contractor to comply with all applicable federal, state, and/or local statutes, orders, rules, regulations, ordinances, and/or directives relating to construction site safety in connection with COVID-19 **(or any other governmentally declared infectious disease, pestilence or virus)**, and or any similar virus or derivative strain. The Contract Price shall include all such costs of compliance.
- 5) Contractor shall ensure that all its employees and its Subcontractor employees comply with all applicable construction site safety requirements, including, without limitation, those related to COVID-19 **(or any other governmentally declared infectious disease, pestilence or virus)** or any other similar virus or derivative strain.
 - a) Implementation and maintenance of safety programs shall be the sole responsibility of the Contractor.
 - b) Contractor shall furnish to the District a copy of the Contractor's safety plan within the time frame indicated in the Contract Documents and specifically adapted for the Project.
 - c) Contractor shall be responsible for all damages to persons or property that occur as a result of its fault or negligence in connection with the performance of the Contract and shall take all necessary measures and be responsible for the proper care and completion and final acceptance by District. All Work shall be solely at

Contractor's risk with the exception of damage to the Work caused by "acts of God" as defined in Public Contract Code section 7105.

d) Contractor shall take, and require Subcontractors to take, all necessary precautions for safety of workers on the Project and shall comply with all applicable federal, state, local, and other safety laws, standards, orders, rules, regulations, and building codes to prevent accidents or injury to persons on, about, or adjacent to premises where Work is being performed and to provide a safe and healthful place of employment. Contractor shall furnish, erect, and properly maintain at all times, all necessary safety devices, safeguards, construction canopies, signs, nets, barriers, lights, and watchmen for protection of workers and the public and shall post danger signs warning against hazards created by such features in the course of construction.

1

RFI #1

PRE-BID CLARIFICATION FORM

(Email this completed form to FacilitiesBid@rsccd.edu. See Instructions to Bidders.)

PROJECT NAME:	Campus Entrance Improvements Phase 2 Project at Santiago Canyon College		
PROJECT NUMBER:	3742	BID NUMBER:	1472
EMAIL TO: facilitiesbid@rsccd.edu			
DATE:	3/5/2025		
FROM:	Ryan Agnew - RJR Water Features	EMAIL:	ragnew@rjrwaterfeatures.com
SPEC SECTION:	Electrical/Controls	DRAWING NUMBER:	F-1.06 & F-1.07
REQUESTED CLARIFICATION:			
<p>The equipment load schedule on F-1.06 and the electrical schematic on F-1.07 do not match.</p> <p>F-1.06 matches the equipment shown throughout the plans, while F-1.07 has multiple additional items not shown on the plans.</p> <p>Please advise if a revised electrical schematic will be provided.</p>			
RESPONSE TO CLARIFICATION:			
<p>Please use Addendum 2, revised electrical sheets F-1.05, F-1.06, and F-1.07.</p> <p>SVA, 3/13/2025</p>			

Attach additional numbered sheets as necessary; however, only one (1) request shall be contained on each submitted form.

END OF DOCUMENT

RFI #2

PRE-BID CLARIFICATION FORM

(Email this completed form to FacilitiesBid@rsccd.edu. See Instructions to Bidders.)

PROJECT NAME:	Campus Entrance Improvements Phase 2 Project at Santiago Canyon College		
PROJECT NUMBER:	3742	BID NUMBER:	1472
EMAIL TO: facilitiesbid@rsccd.edu			
DATE:	3/5/2025		
FROM:	Ryan Agnew - RJR Water Features	EMAIL:	ragnew@rjrwaterfeatures.com
SPEC SECTION:	Electrical/Controls	DRAWING NUMBER:	F-1.06
REQUESTED CLARIFICATION:			
<p>Clarification is needed on the fountain lighting controls. Is the fountain control panel providing power AND control for the lights located in the fountain basins, or are the lights being controlled by an external controller?</p>			
RESPONSE TO CLARIFICATION:			
<div style="border: 2px solid green; padding: 10px; margin-top: 10px;"><p>The fountain control will provide lighting power. Please use Addendum 2, revised electrical sheets F-1.05, F-1.06, and F-1.07.</p><p>SVA, 3/13/2025</p></div>			

Attach additional numbered sheets as necessary; however, only one (1) request shall be contained on each submitted form.

END OF DOCUMENT

RFI #3

PRE-BID CLARIFICATION FORM

(Email this completed form to FacilitiesBid@rsccd.edu. See Instructions to Bidders.)

PROJECT NAME:	Campus Entrance Improvements Phase 2 Project at Santiago Canyon College		
PROJECT NUMBER:	3742	BID NUMBER:	1472
EMAIL TO: facilitiesbid@rsccd.edu			
DATE:	3/5/2025		
FROM:	Rob Regan - RJR Water Features	EMAIL:	rregan@rjrwaterfeatures.com
SPEC SECTION:	Waterproofing Material/Limits	DRAWING NUMBER:	1/F-1.04
REQUESTED CLARIFICATION:			
<p>The waterproofing detail on F1.04 calls for CIM 1000 in discharge trough and Mapeilastic under upper SS Saw Tooth Stone Section.</p> <p>In the detail it shows Mapeilastic down the steps of the fountain.</p> <p>What are the limits of waterproofing?</p> <ul style="list-style-type: none">- Does it continue throughout fountain lower basin?- How far up wing walls does it extend and how does it terminate?- How far up lower basin perimeter wall and how does it terminate?- Is waterproofing exposed?			
RESPONSE TO CLARIFICATION:			
<div style="border: 2px solid green; padding: 10px; margin: 10px;"><p>- The Mapei products are used under the stonework only as a mounting system.</p><p>- The lower basins do not have a waterproofing membrane, they have Xypex admix.</p><p>- No membrane on the wing walls.</p><p>- The only exposed waterproofing is the CIM1000 in the troughs.</p><p>SVA, 3/13/2025</p></div>			

Attach additional numbered sheets as necessary; however, only one (1) request shall be contained on each submitted form.

END OF DOCUMENT

RFI #4

PRE-BID CLARIFICATION FORM

(Email this completed form to FacilitiesBid@rsccd.edu. See Instructions to Bidders.)

PROJECT NAME:	Campus Entrance Improvements Phase 2 Project at Santiago Canyon College		
PROJECT NUMBER:	3742	BID NUMBER:	1472
EMAIL TO: facilitiesbid@rsccd.edu			
DATE:	3/5/2025		
FROM:	Ryan Agnew - RJR Water Features	EMAIL:	ragnew@rjrwaterfeatures.com
SPEC SECTION:		DRAWING NUMBER:	3/F-1.04
REQUESTED CLARIFICATION:			
<p>The waterstop detail 3/F-1.04 does not match the waterstops called out on pages F-1.02 & F-1.03. Also, a waterstop is not specified for the conduit penetrations for the pumps and lights.</p> <p>Please clarify what type of waterstop should be used for all fountain pipe penetrations, and if waterstops are needed for the conduit penetrations.</p>			
RESPONSE TO CLARIFICATION:			
<p>Where called out specifically, use the specified waterstop method. Otherwise, use 3/F-1.04.</p> <p>For the conduits, please use the waterstop called out on 5/F-1.07 on the Addendum 2 sheet.</p> <p>SVA, 3/13/2025</p>			

Attach additional numbered sheets as necessary; however, only one (1) request shall be contained on each submitted form.

END OF DOCUMENT

RFI #5**PRE-BID CLARIFICATION FORM***(Email this completed form to FacilitiesBid@rsccd.edu. See Instructions to Bidders.)*

PROJECT NAME:	Campus Entrance Improvements Phase 2 Project at Santiago Canyon College		
PROJECT NUMBER:	3742	BID NUMBER:	1472
EMAIL TO: facilitiesbid@rsccd.edu			
DATE:	3/5/2025		
FROM:	LA Engineering Jayson Lau	EMAIL:	j1lau@laeng.net
SPEC SECTION:		DRAWING NUMBER:	CD-1.0 / L-6.01
REQUESTED CLARIFICATION:		Relocate Trees LAE-003	
<p>Is there a location on campus where the trees that are to be removed and relocated can be temporarily stored in-ground prior to transplanting to their permanent location?</p>			
RESPONSE TO CLARIFICATION: <p>Transplanted palm trees are to remain in their existing locations until the new locations are prepared. Palms that cannot be transplanted immediately can stay out of the soil for up to 36 hours before they must be planted in their final location. Palms out of the soil for more than 4 hours must be protected from the elements until they are relocated to their final location. If locations of existing palms cause significant hardship to the contractor during the course of construction, or if construction activities will overly stress the existing palm trees to be transplanted, the contractor may plant the palm trees in a temporary location assuming the final proposed location is not yet available. Preparation of the temporary location of the palm tree to be per specification section 32 93 44, section 32 96 43, and detail 6, sheet L-7.02. Contractor is not required to connect temporary palm planting locations to the stormdrain system, but will need to include temporary observation pipes and monitor the palms daily to ensure adequate soil drainage. All transplanting of palms to be done under the care of an ISA master arborist and palm specialist. ISA master arborist and palm specialists to be pre-approved by architect. Location of temporary palm locations to be per district direction. Temporary palm locations to be reviewed and approved by architect and palm specialist prior to start of construction and relocation. On-site temporary palm locations to be determined and coordinated with District and college staff. The contractor shall procure new replacement palms to match existing if an on-site temporary location cannot be determined. Size and type to be specified by the architect. Refer to "Attachment for RFI#5" for additional information.</p> <p>RSCCD, 3/13/2025</p>			

Attach additional numbered sheets as necessary; however, only one (1) request shall be contained on each submitted form.

END OF DOCUMENT

RFI #6

PRE-BID CLARIFICATION FORM

(Email this completed form to FacilitiesBid@rsccd.edu. See Instructions to Bidders.)

PROJECT NAME:	Campus Entrance Improvements Phase 2 Project at Santiago Canyon College		
PROJECT NUMBER:	3742	BID NUMBER:	1472
EMAIL TO: facilitiesbid@rsccd.edu			
DATE:	3/5/2025		
FROM:	Griffin Mulvey The J.V. Land Clearing Co., Inc.	EMAIL:	griffin@thejvco.com
SPEC SECTION:	Demolition / Existing Conditions	DRAWING NUMBER:	CD-1.0
REQUESTED CLARIFICATION:			
<p>Question 1: Soils report does not identify the thickness of the asphalt dropoff / firelane area that is getting demolished. Soils report does not identify if the asphalt contains petromat in this area. Boring B-1 identified AC pavement to be 2.5" thick but does not provide asphalt thickness in area getting demolished.</p> <p>Question 2: Soils report does not identify thickness of concrete / brick firelane that is getting demolished. P-2 identified concrete to be 4" thick but does not provide concrete thickness in firelane area getting demolished.</p>			
RESPONSE TO CLARIFICATION:			
<p>Response to Question 1: Refer to "Attachment #1 for RFI#6" for locations of asphalt thickness.</p> <p>RSCCD, 3/13/2025</p> <p>Response to Question 2: Per as-builts provided by the District, the thickness of concrete / brick fire lane getting demolished is 6-inches thick - see attached As-built sheet 'AS-2' and "Attachment #2 for RFI#6"</p> <p>SVA, 3/13/2025</p>			

Attach additional numbered sheets as necessary; however, only one (1) request shall be contained on each submitted form.

END OF DOCUMENT

RFI #7

PRE-BID CLARIFICATION FORM

(Email this completed form to FacilitiesBid@rsccd.edu. See Instructions to Bidders.)

PROJECT NAME:	Campus Entrance Improvements Phase 2 Project at Santiago Canyon College		
PROJECT NUMBER:	3742	BID NUMBER:	1472
EMAIL TO: facilitiesbid@rsccd.edu			
DATE:	03/06/2025		
FROM:	Marina Landscape, Inc.	EMAIL:	QNguyen@marinaco.com
SPEC SECTION:		DRAWING NUMBER:	L-3.02 & L-4.01
REQUESTED CLARIFICATION:			
Irrigation equipment legend/L-3.02 shows jumbo rectangular valve box for ball valve. However, detail F/L-4.01 shows rectangular valve box for ball valve. Please clarify.			
RESPONSE TO CLARIFICATION:			
<div style="color: red; font-weight: bold;">3" Ball Valve box shall be Jumbo Size 13" X 20" for extra room to operate the valve.</div> <div style="color: red; font-weight: bold;">-Chris Curry, Glasir Design - 3/11/2025</div>			

Attach additional numbered sheets as necessary; however, only one (1) request shall be contained on each submitted form.

END OF DOCUMENT

RFI #8

PRE-BID CLARIFICATION FORM

(Email this completed form to FacilitiesBid@rsccd.edu. See Instructions to Bidders.)

PROJECT NAME:	Campus Entrance Improvements Phase 2 Project at Santiago Canyon College		
PROJECT NUMBER:	3742	BID NUMBER:	1472
EMAIL TO: facilitiesbid@rsccd.edu			
DATE:	03/06/2025		
FROM:	Marina Landscape, Inc.	EMAIL:	QNguyen@marinaco.com
SPEC SECTION:		DRAWING NUMBER:	L-7.01
REQUESTED CLARIFICATION:			
Please provide size for pea gravel per legend#11, detail 5/L-7.01.			
RESPONSE TO CLARIFICATION:			
<div style="color: red;">Pea Gravel to be 3/8"</div> <div style="color: red;">-Sara Ryan RJM Design Group 03/10/25</div>			

Attach additional numbered sheets as necessary; however, only one (1) request shall be contained on each submitted form.

END OF DOCUMENT

RFI #9

PRE-BID CLARIFICATION FORM

(Email this completed form to FacilitiesBid@rsccd.edu. See Instructions to Bidders.)

PROJECT NAME:	Campus Entrance Improvements Phase 2 Project at Santiago Canyon College		
PROJECT NUMBER:	3742	BID NUMBER:	1472
EMAIL TO: facilitiesbid@rsccd.edu			
DATE:	03/06/2025		
FROM:	Marina Landscape, Inc.	EMAIL:	QNguyen@marinaco.com
SPEC SECTION:		DRAWING NUMBER:	L-6.01
REQUESTED CLARIFICATION:			
Please provide material for gravel mulch at french drain per legend/L-6.01.			
RESPONSE TO CLARIFICATION:			
<p>Gravel mulch is existing. Contractor to weed the French drain area. Contractor is responsible for replenishing the gravel mulch where construction activities disturb existing conditions at no additional cost to the owner. Gravel mulch to match existing.</p> <p>-Sara Ryan RJM Design Group 03/10/2025</p>			

Attach additional numbered sheets as necessary; however, only one (1) request shall be contained on each submitted form.

END OF DOCUMENT

RFI #10

PRE-BID CLARIFICATION FORM

(Email this completed form to FacilitiesBid@rsccd.edu. See Instructions to Bidders.)

PROJECT NAME:	Campus Entrance Improvements Phase 2 Project at Santiago Canyon College		
PROJECT NUMBER:	3742	BID NUMBER:	1472
EMAIL TO: facilitiesbid@rsccd.edu			
DATE:	03/06/2025		
FROM:	Marina Landscape, Inc.	EMAIL:	QNguyen@marinaco.com
SPEC SECTION:	328400	DRAWING NUMBER:	L-4.01
REQUESTED CLARIFICATION:			
Specification 3.2/328400 shows minimum cover of 24 inches on pressure supply lines in planters. However, detail J/L-4.01 shows 18" cover mainline pipe. Please clarify.			
RESPONSE TO CLARIFICATION:			
<p style="color: red; margin: 0;">Mainline pipe depth is to be 24" with the wires.</p> <p style="color: red; margin: 0;">-Chris Curry, Glasir Design 3/11/2025</p>			

Attach additional numbered sheets as necessary; however, only one (1) request shall be contained on each submitted form.

END OF DOCUMENT

RFI #11

PRE-BID CLARIFICATION FORM

(Email this completed form to FacilitiesBid@rsccd.edu. See Instructions to Bidders.)

PROJECT NAME:	Campus Entrance Improvements Phase 2 Project at Santiago Canyon College		
PROJECT NUMBER:	3742	BID NUMBER:	1472
EMAIL TO: facilitiesbid@rsccd.edu			
DATE:	3/5/2025		
FROM:	Ryan Agnew - RJR Water Features	EMAIL:	ragnew@rjrwaterfeatures.com
SPEC SECTION:		DRAWING NUMBER:	2/L-2.03 - Note C
REQUESTED CLARIFICATION:			
<p>This note reads:</p> <p>© CONTRACTOR TO CREATE AN ARCHITECTURAL MODEL AT $\frac{1}{4}"=1'-0"$ SCALE OF PROPOSED FOUNTAIN IMPROVEMENTS BY CONTRACTING WITH GLENN R. JOHNSON SCALE MODELS. CONTRACTOR RESPONSIBLE FOR COORDINATING LEAD TIMES AND REQUIRED DEPOSITS IN ORDER TO ALLOW FOR ARCHITECT REVIEW AND APPROVAL PRIOR TO FABRICATION OF FULL SCALE, ON SITE FOUNTAIN. CONTACT ANTHONY PREVOSTO AT (714) 538-94229. CONTRACTOR TO INCLUDE $\frac{1}{4}"$ THICK CLEAR PLEXIGLASS DUST COVER.</p> <p>Is this model still in the scope of work? Or has this model already been provided and approved?</p>			
RESPONSE TO CLARIFICATION:			
<p>The model is not in the scope of work and does not need to be provided. Contractor to provide shop drawings and 3-D rendering models in lieu of physical model.</p> <p>RSCCD, 3/13/2025</p>			

Attach additional numbered sheets as necessary; however, only one (1) request shall be contained on each submitted form.

END OF DOCUMENT

RFI #12

PRE-BID CLARIFICATION FORM

(Email this completed form to FacilitiesBid@rsccd.edu. See Instructions to Bidders.)

PROJECT NAME:	Campus Entrance Improvements Phase 2 Project at Santiago Canyon College		
PROJECT NUMBER:	3742	BID NUMBER:	1472
EMAIL TO: facilitiesbid@rsccd.edu			
DATE:	3/6/25		
FROM:	Wallace Electric Services Inc. Paul Wallace	EMAIL:	wallaceelectricpgw@gmail.com
SPEC SECTION:	Reconstruction notes #2	DRAWING NUMBER:	E-103
REQUESTED CLARIFICATION:			
Reconstruction note #2 states to provide power from DBP to new Fountain power panel. Panel DBP is not on page E-103 or Building D page E-200. I assume it is located in the Electrical room of Building D but want clarification where it is located.			
RESPONSE TO CLARIFICATION:			
<p style="color: red; margin: 0;">Yes switchboard DBP located in Building D electrical room D112.</p> <p style="color: red; margin: 0;">Jocelin Lam, Goss Engineering 3/11/2025</p>			

Attach additional numbered sheets as necessary; however, only one (1) request shall be contained on each submitted form.

END OF DOCUMENT

RFI #13**PRE-BID CLARIFICATION FORM**

(Email this completed form to FacilitiesBid@rsccd.edu. See Instructions to Bidders.)

PROJECT NAME:	Campus Entrance Improvements Phase 2 Project at Santiago Canyon College		
PROJECT NUMBER:	3742	BID NUMBER:	1472
EMAIL TO: facilitiesbid@rsccd.edu			
DATE:	3/6/25		
FROM:	Wallace Electric Services Inc. Paul Wallace	EMAIL:	wallaceelectricpgw@gmail.com
SPEC SECTION:	Reconstruction notes #4	DRAWING NUMBER:	E-103
REQUESTED CLARIFICATION:			
<p>Reconstruction note #4 states to stub up 1" Conduit in planter for future speaker and route it back to the electrical room. There is no #4 sited on page E-103. Please clarify where the location is.</p>			
RESPONSE TO CLARIFICATION:			
<p>Future speakers removed from scope, ignore note 4.</p> <p>Jocelin Lam, Goss Engineering 3/11/2025</p>			

Attach additional numbered sheets as necessary; however, only one (1) request shall be contained on each submitted form.

END OF DOCUMENT

RFI #14**PRE-BID CLARIFICATION FORM**

(Email this completed form to FacilitiesBid@rsccd.edu. See Instructions to Bidders.)

PROJECT NAME:	Campus Entrance Improvements Phase 2 Project at Santiago Canyon College		
PROJECT NUMBER:	3742	BID NUMBER:	1472
EMAIL TO: facilitiesbid@rsccd.edu			
DATE:	3/6/25		
FROM:	Wallace Electric Services Inc. Paul Wallace	EMAIL:	wallaceelectricpgw@gmail.com
SPEC SECTION:	Reconstruction notes #5	DRAWING NUMBER:	E-103
REQUESTED CLARIFICATION:			
<p>Reconstruction note #5 states to provide 1 1/2" C and CAT-6A to IDF room in building D. The IDF room is not on page E-103 or Building D page E-200. Need clarification where the IDF room is located.</p>			
RESPONSE TO CLARIFICATION:			
<p>Telecom backboard located in main electrical room D112.</p> <p>Jocelin Lam, Goss Engineering 3/11/2025</p>			

Attach additional numbered sheets as necessary; however, only one (1) request shall be contained on each submitted form.

END OF DOCUMENT

RFI #15

PRE-BID CLARIFICATION FORM

(Email this completed form to FacilitiesBid@rsccd.edu. See Instructions to Bidders.)

PROJECT NAME:	Campus Entrance Improvements Phase 2 Project at Santiago Canyon College		
PROJECT NUMBER:	3742	BID NUMBER:	1472
EMAIL TO: facilitiesbid@rsccd.edu			
DATE:	3/11/25		
FROM:	Wallace Electric Services Inc. Paul Wallace	EMAIL:	wallaceelectricpgw@gmail.com
SPEC SECTION:	Reconstruction notes #7	DRAWING NUMBER:	E-103
REQUESTED CLARIFICATION:			
<p>Reconstruction note #7 states to provide a 12' x 6' pull box and label it data. Does the box need to be that size? The pull box detail on page E-501 shows a 2' x 3' box which looks to be the correct size. also there will be both electrical and data in the box. Should it be labeled Electrical instead of data?</p>			
RESPONSE TO CLARIFICATION:			
<p>Yes 2'x3' box per detail for both data and power. Provide divider in box to separate data and power. Name box as 'Electrical'.</p> <p>Jocelin Lam, Goss Engineering 3/12/2025</p>			

Attach additional numbered sheets as necessary; however, only one (1) request shall be contained on each submitted form.

END OF DOCUMENT

RFI #16

PRE-BID CLARIFICATION FORM

(Email this completed form to FacilitiesBid@rsccd.edu. See Instructions to Bidders.)

PROJECT NAME:	Campus Entrance Improvements Phase 2 Project at Santiago Canyon College		
PROJECT NUMBER:	3742	BID NUMBER:	1472
EMAIL TO: facilitiesbid@rsccd.edu			
DATE:	3/5/2025		
FROM:	LA Engineering Jayson Lau	EMAIL:	jlau@laeng.net
SPEC SECTION:		DRAWING NUMBER:	ATTCH_C Logistics & Phasing
REQUESTED CLARIFICATION:		Sound Blankets LAE-001	
<p>Does the height of the sound blankets extend only to the height of the temporary fence? (not higher than, or a minimum height?)</p> <p>Also, is privacy screening required on the temporary fence that has sound blankets?</p>			
RESPONSE TO CLARIFICATION:			
<p>The height of the sound blankets need to extend to the height of the construction fence.</p> <p>No. Privacy screen is not required.</p> <p>RSCCD, 3/13/2025</p>			

Attach additional numbered sheets as necessary; however, only one (1) request shall be contained on each submitted form.

END OF DOCUMENT

RFI #17

PRE-BID CLARIFICATION FORM

(Email this completed form to FacilitiesBid@rsccd.edu. See Instructions to Bidders.)

PROJECT NAME:	Campus Entrance Improvements Phase 2 Project at Santiago Canyon College		
PROJECT NUMBER:	3742	BID NUMBER:	1472
EMAIL TO: facilitiesbid@rsccd.edu			
DATE:	3/5/2025		
FROM:	LA Engineering Jayson Lau	EMAIL:	jlau@laeng.net
SPEC SECTION:	Various	DRAWING NUMBER:	
REQUESTED CLARIFICATION:		LAE-002	
<p>1. What is the Engineer's Estimate for this project?</p> <p>2. What is the Allowance amount to include in our bid?</p>			
RESPONSE TO CLARIFICATION:			
<p>1. The engineer's estimate is \$6,500,000 to \$7,200,000.</p> <p>2. The allowance for this project will be established by the District once the bids have been received. The total contract amount will include the District allowance.</p> <p>RSCCD, 3/13/2025</p>			

Attach additional numbered sheets as necessary; however, only one (1) request shall be contained on each submitted form.

END OF DOCUMENT

RFI #18**PRE-BID CLARIFICATION FORM**

(Email this completed form to FacilitiesBid@rsccd.edu. See Instructions to Bidders.)

PROJECT NAME:	Campus Entrance Improvements Phase 2 Project at Santiago Canyon College		
PROJECT NUMBER:	3742	BID NUMBER:	1472
EMAIL TO: facilitiesbid@rsccd.edu			
DATE:	3/5/25		
FROM:	2H Construction	EMAIL:	ryan@2hconstruction.com
SPEC SECTION:	01 21 00	DRAWING NUMBER:	
REQUESTED CLARIFICATION:			
<p>Allowance Section 01 21 00 3.01 states the contractor to include the following allowances in the base bid however the amount for Allowance #1 is to be determined. Please provide allowance amount or state the allowance will not be a part of the base bid.</p>			
RESPONSE TO CLARIFICATION:			
<p>1. The allowance for this project will be established by the District once the bids have been received. The base bid does not include the allowance, as stated in section 01 21 00 3.01 the allowance is "TO BE DETERMINED". The total contract amount will include the District allowance.</p> <p>RSCCD, 3/13/2025</p>			

Attach additional numbered sheets as necessary; however, only one (1) request shall be contained on each submitted form.

END OF DOCUMENT

RFI #19

PRE-BID CLARIFICATION FORM

(Email this completed form to FacilitiesBid@rsccd.edu. See Instructions to Bidders.)

PROJECT NAME:	Campus Entrance Improvements Phase 2 Project at Santiago Canyon College		
PROJECT NUMBER:	3742	BID NUMBER:	1472
EMAIL TO: facilitiesbid@rsccd.edu			
DATE:	3/6/25		
FROM:	2H Construction	EMAIL:	ryan@2hconstruction.com
SPEC SECTION:		DRAWING NUMBER:	
REQUESTED CLARIFICATION:			
<p>Local Hire Business GFE Worksheet is noted as to be submitted if option 3 is selected. However the GFE Worksheet is also listed as a mandatory bid submittal on the checklist. If the contractor selects option 1 or 2 for Local Hire and Business Participation, is the good faith effort and Local Hire Business GFE Worksheet still required to be submitted?</p>			
RESPONSE TO CLARIFICATION:			
<p>The local hire GFE is only required if Option 3 is selected.</p> <p>RSccd, 3/13/2025</p>			

Attach additional numbered sheets as necessary; however, only one (1) request shall be contained on each submitted form.

END OF DOCUMENT

DAILY REPORT OF FIELD OBSERVATIONS

Service Date: 03/12/2025

Ninyo & Moore

Geotechnical and Environmental Sciences Consultants

475 Goddard, Suite 200

Irvine CA 92618

949.753.7070 | www.ninyoandmoore.com

Project Name: Santiago Canyon College Entrance Phase 2 - Asphalt Coring **Project Number:** 212906002

Project Address: 8045 E. Chapman Ave
Orange CA 92869 **Jurisdiction:** RSCCD

Client: Rancho Santiago Community College District **Permit:** N/A

General Contractor: N/A **Plan File No.** N/A

Approved Documents: Plans and Specifications

Equipment: Hilti Coring Rig**Summary of Field Services:**

I went to Ninyo and Moore to pick up the coring rig and equipment and headed to the site. I arrived on site at 1:00 pm as requested and communicated with Jim Nemecheck to go over the scope of work and to locate the areas for the coring.

Asphalt Coring in the Student Drop-off (3)

A Hilti Coring Rig with a 4" coring barrel was used to collect and measure three (3) cores in the areas that were predetermined by Jim.

Jim assisted with the traffic control around the coned off area where the coring took place. Jim measured the cores and took photos to record the size. Perma-Patch was used to fill in the voids of the cored areas.

Once the required coring was performed, I completed my documentation, loaded up the equipment and returned to Ninyo and Moore to store them accordingly.

Weather: Cloudy, Light Breeze, High Humidity, Intermittent drizzle**SIGNATURES**

Start Time	Stop Time	Regular Hours	Overtime Hours	No. of Test Specimens	
12:00	16:00	4	-	0	Miguel Robles (Print)
CODE: RW = Rework NIC = Not In Contract ST = Standby WC = Work Cancelled Code - (No. of hours)					Signature of Field Technician 03/12/2025 01641056
THE WORK <input checked="" type="checkbox"/> was / <input type="checkbox"/> was not inspected in accordance with the approved documents THE WORK INSPECTED <input checked="" type="checkbox"/> met / <input type="checkbox"/> did not meet the requirements of the approved documents MATERIAL SAMPLING <input checked="" type="checkbox"/> was <input type="checkbox"/> was not <input type="checkbox"/> N/A performed in accordance with the approved documents					Date Certification Number JOB SITE CONTACT IS ASKED TO SIGN TO VERIFY INSPECTION HOURS ONLY THE CONTENT OF THIS REPORT & FEE CHARGES ARE THE RESPONSIBILITY OF OTHERS Signature of Owner-Authorized Job Site Contact

DAILY REPORT OF FIELD OBSERVATIONS

Service Date: 03/12/2025
Project Name: Santiago Canyon College Entrance Phase 2 - Asphalt Coring

Client: Rancho Santiago Community College District
Project Number: 212906002

FIELD OBSERVATION PICTURES



Core from the Eastern Entrance of the Student Drop-off



Core from the Middle of the Student Drop-off



Core in front of the Admin Building



Asphalt thickness: ~4"

Asphalt thickness: ~5.5"

Asphalt thickness: ~5"

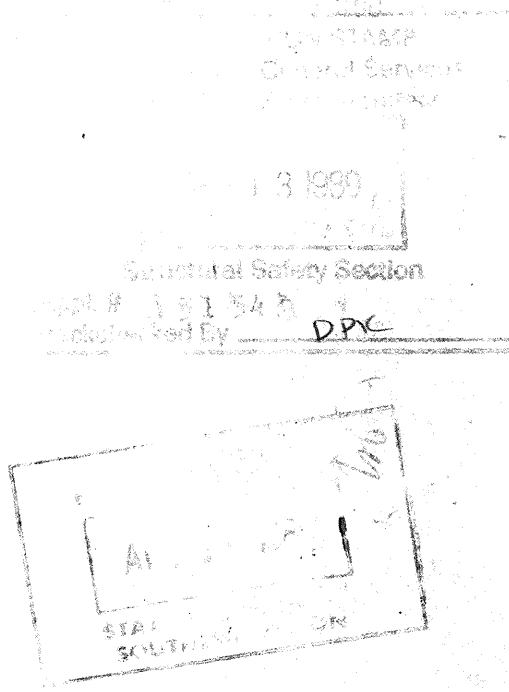

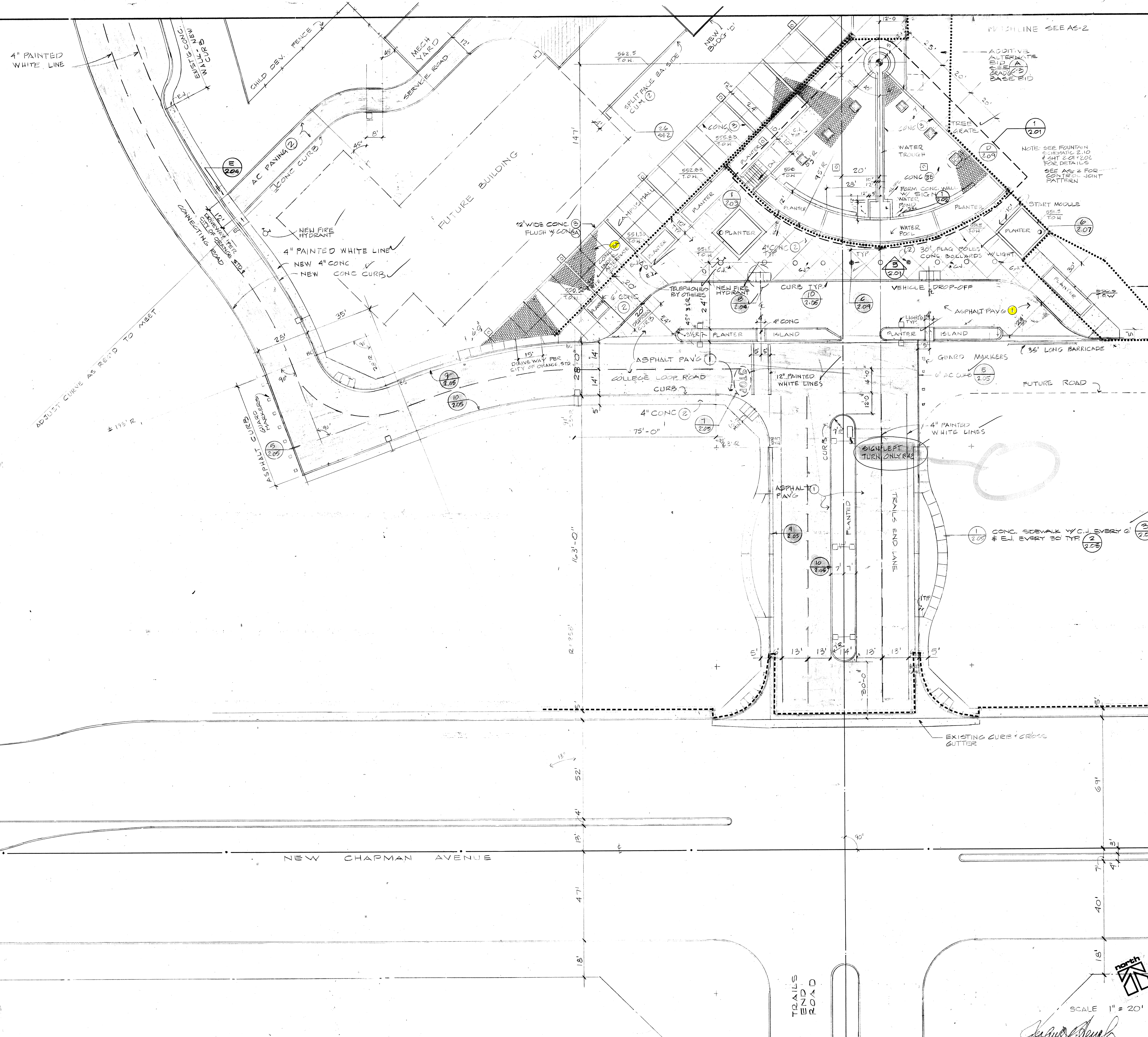

NOTE: LEGEND OF MATERIALS ON SHEET 1.02

VCA: THIS SHEET WASNT INCLUDED IN THE AS-BUILT SET

REVISIONS	2-25
DATE	7/12/20
DRAWN	JAB
JOB NO.	2879

Orange Campus **Rancho Santiago College** Building Increment 2 Rancho Santiago Community College District

The Blurock Partnership
Architects and Planners
2300 Newport Boulevard / Newport Beach, California 92663 / Telephone No. (714) 873-0300

SITE PLAN
SCALE 1" = 20'-0"



Attachment #2 for RFI#6



- 1 REMOVE EXISTING SLOPE PAVEMENT AND BASE MATERIAL, FULL DEPTH.
- 2 REMOVE EXISTING DRIVE PAVEMENT AND BASE MATERIAL, FULL DEPTH.
- 3 WASH AND CLEAN SURFACE FOR SLURRY COAT.
- 4 CLEAR, GRUB AND REMOVE EXISTING TUPERS/PLANTERS/SHRUBS/EXPOSED SUGARCANE AREA, REMOVE EXISTING SHRUBS AND ROOTS IN THEIR ENTIRETY.
- 5 REMOVE EXISTING 7 THICK AC PAVEMENT AND BASE MATERIAL, FULL DEPTH.
- 6 REMOVE EXISTING MONOPY IN ITS ENTIRETY.
- 7 REMOVE EXISTING SIGL POST AND FOUNDATION IN ITS ENTIRETY, REFER TO LANDSCAPE DRAWINGS FOR NEW LOCATION.
- 8 REMOVE EXISTING SIGN IN ITS ENTIRETY, REFER TO LANDSCAPE DRAWINGS AND COORDINATE WITH DISTRICT PRIOR TO REMOVAL.
- 9 REMOVE EXISTING STAIRS AND HANDRAIL IN ITS ENTIRETY.
- 10 REMOVE EXISTING RETAINING WALL AND FOOTING IN ITS ENTIRETY.
- 11 REMOVE AND STORE EXISTING MONUMENT FOR REUSE, REATTACH PER APPROVED METHOD OF INSTALLATION, SEE LANDSCAPE DRAWINGS FOR NEW LOCATION.
- 12 REMOVE EXISTING CONCRETE CURB IN ITS ENTIRETY.
- 13 REMOVE PORTION OF EXISTING CONCRETE RAMP IN ITS ENTIRETY.
- 14 REMOVE EXISTING CURB AND GUTTER IN ITS ENTIRETY.
- 15 REMOVE EXISTING RAISED PLANTER AND SEAT WALL AND FOOTINGS IN ITS ENTIRETY.
- 16 REMOVE AND RELOCATE EXISTING TREE IN ITS ENTIRETY, REFER TO LANDSCAPE DRAWINGS AND COORDINATE WITH DISTRICT PRIOR TO REMOVAL AND RELOCATION.
- 17 REMOVE EXISTING RAMP HANDRAILS IN ITS ENTIRETY.
- 18 REMOVE EXISTING PORTION OF EXISTING RAMP, WALL AND FOOTING IN ITS ENTIRETY.
- 19 REMOVE EXISTING SOLLARO AND FOOTING IN ITS ENTIRETY.
- 20 REMOVE AND STORE EXISTING BIKR BACK FOR REUSE, SANDBLAST AND GALVANIZE, SEE LANDSCAPE DRAWINGS FOR NEW LOCATION.
- 21 REMOVE EXISTING FLAG POLE AND FOOTING IN ITS ENTIRETY.
- 22 REMOVE AND STORE EXISTING WALL MOUNTED PLAQUE FOR REUSE, REATTACH PER APPROVED METHOD OF INSTALLATION, SEE LANDSCAPE DRAWINGS FOR NEW LOCATION.
- 23 REMOVE AND STORE EXISTING LETTERS FROM BOTH SIDES OF SIGL, SEE LANDSCAPE AND ELECTRICAL DRAWINGS FOR NEW LOCATION OF LETTERS.
- 24 REMOVE EXISTING CONCRETE CURB RAMP IN ITS ENTIRETY.
- 25 REMOVE EXISTING GATE POST AND FOOTING IN ITS ENTIRETY.
- 26 REMOVE EXISTING CURB, GUTTER AND CROSS GUTTER, REMOVE TO NEAREST JOINT.
- 27 REMOVE EXISTING BIKR BACK IN ITS ENTIRETY.
- 28 REMOVE AND RELOCATE EXISTING GOLF DROP BIN FOR REUSE, SEE LANDSCAPE DRAWINGS FOR NEW LOCATION.
- 29 REMOVE EXISTING HANDRAILS AND FOOTINGS IN ITS ENTIRETY.
- 30 REMOVE EXISTING STRIPPINGS IN ITS ENTIRETY.
- 31 REMOVE AND RELOCATE EXISTING BLUE LIGHT EMERGENCY PHONE, SEE ARCHITECTURAL AND LANDSCAPE DRAWINGS FOR NEW LOCATION.
- 32 GRIND TOP 1" MINIMUM OF EXISTING AC PAVEMENT.

51	PROJECT IN PLACE EXISTING TREES, SHRUBS, SOO, ETC.
52	PROJECT IN PLACE EXISTING CONCRETE WALL AND FOOTINGS IN ITS ENTIRETY.
53	PROJECT IN PLACE EXISTING BUILDING, FOOTINGS, AND ALL APPLICABLES IN ITS ENTIRETY.
54	PROJECT IN PLACE EXISTING BRICK PAVEMENT AND BASE MATERIAL, FULL DEPTH.
55	PROJECT IN PLACE EXISTING ASPHALT PAVEMENT IN ITS ENTIRETY.
56	PROJECT IN PLACE TRAFFIC SIGNAL, MANHOLE IN ITS ENTIRETY.
57	PROJECT IN PLACE EXISTING CONCRETE RAMP IN ITS ENTIRETY.
58	PROJECT IN PLACE EXISTING CONCRETE WALK IN ITS ENTIRETY.
59	PROJECT IN PLACE LEAVING CURB & WALKS ENTIRETY.
60	PROJECT IN PLACE LEAVING CURB & WALKS ENTIRETY.
61	PROJECT IN PLACE EXISTING SIGN IN ITS ENTIRETY.
62	PROJECT IN PLACE EXISTING TREE IN ITS ENTIRETY.
63	PROJECT IN PLACE EXISTING CONCRETE RAMP IN ITS ENTIRETY.
64	PROJECT IN PLACE EXISTING BLUE EMERGENCY FLOW IN ITS ENTIRETY.
65	PROJECT IN PLACE EXISTING PORTION OF RAMP IN ITS ENTIRETY.
66	PROJECT IN PLACE EXISTING CURB IN ITS ENTIRETY.
67	PROJECT IN PLACE EXISTING STAMP IN ITS ENTIRETY.
68	PROJECT IN PLACE EXISTING GRASS IN ITS ENTIRETY.
69	PROJECT IN PLACE EXISTING CONCRETE PAVEMENT IN ITS ENTIRETY.
70	PROJECT IN PLACE EXISTING PARKING TICKET NOOK IN ITS ENTIRETY.
71	PROJECT IN PLACE EXISTING CONCRETE NOW STOPS IN ITS ENTIRETY.

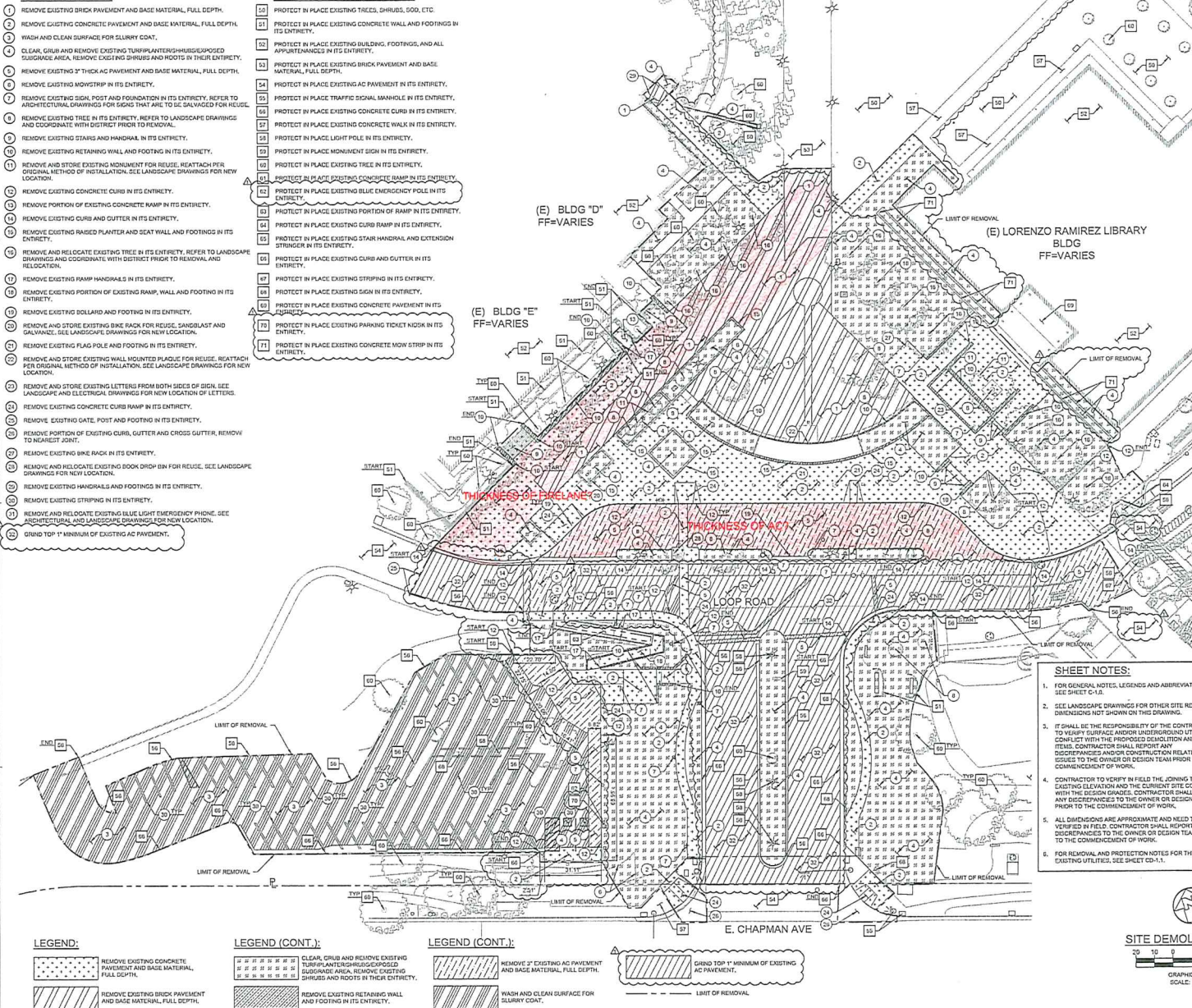

SANTIAGO CANYON COLLEGE
CAMPUS ENTRANCE IMPROVEMENTS PROJECT
PHASE 2

[illegible]

DATE ISSUED: 2024-12-19
PROJECT NO: 2018-4016
DSA APPLICATION NO: 04-12242
SCALE:
SHEET NUMBER: CD-1.
SHEET TITLE:

SITE DEMOLITION PLAN

[illegible]

Attachment #2 for RFI#6

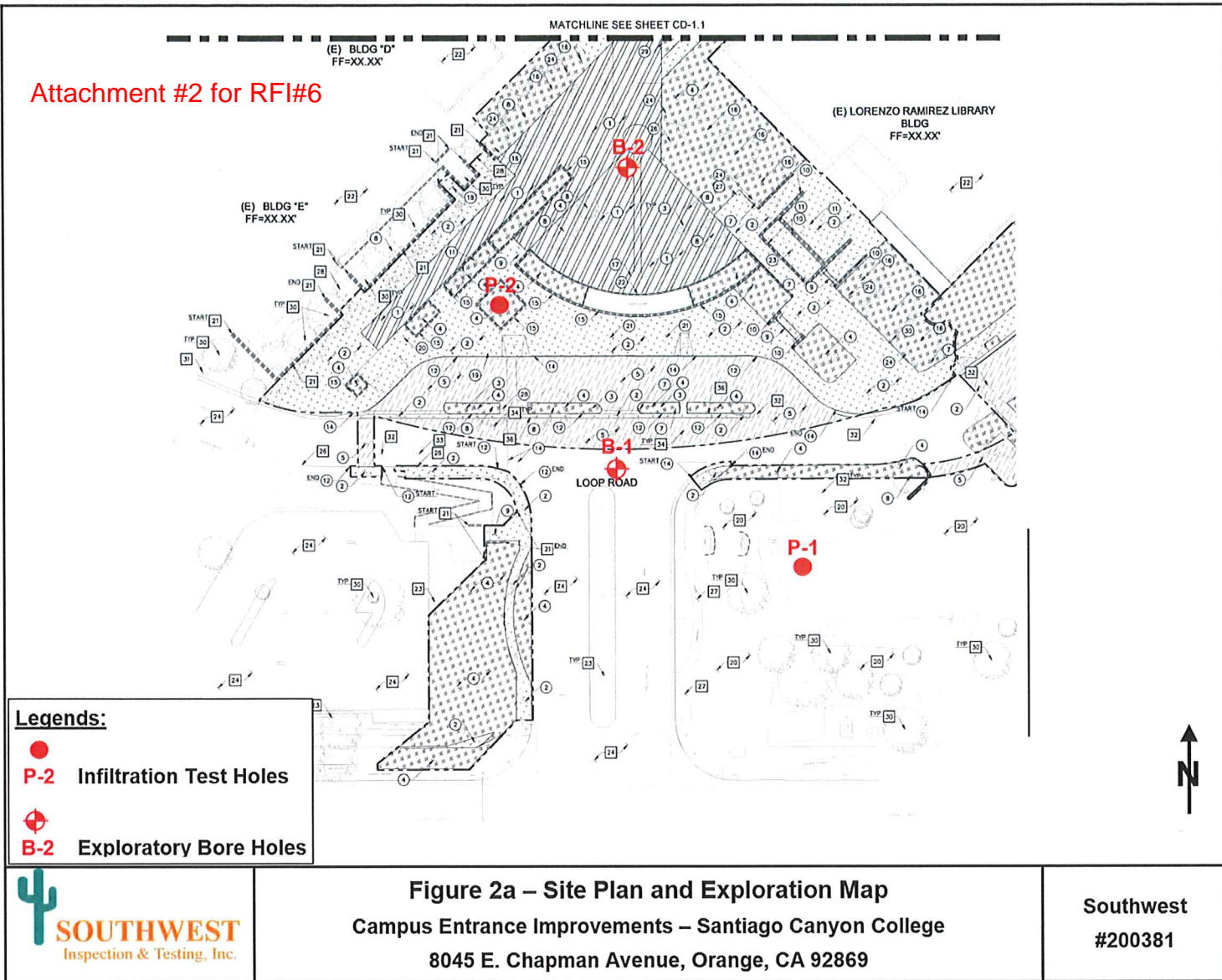

 DRILLING DATE: 11/25/20 DRILLING METHOD: Truck Mounted CME-75 Drilling Rig; 7" Dia. Hollow Stem Auger

 LOGGED BY: MF/GA ELEVATION: ~549 ft LOCATION: See Fig. 2a, Site Plan & Exploration Map

DEPTH (FEET)	SAMPLE NUMBER	BLOWS/FOOT	RING SAMPLE	SPT SAMPLE	BULK SAMPLE	MOISTURE CONTENT (%)	DRY DENSITY (PCF)	CAMPUS ENTRANCE IMPROVEMENTS RSCCD SANTIAGO CANYON COLLEGE 8045 E. CHAPMAN AVENUE, ORANGE, CA 92869 BORE HOLE NO. B-1 SOIL DESCRIPTIONS	SOIL TESTS
2	R-1 B-1	33				14.9	118.1	Surface is asphalt paved, 2.5" asphalt over no base. 0.21' - 5': Dark brown sandy Silt (ML) w/ little clay, fine sand, moist.	Proctor Density, R-Value
5	R-2	64				18.8	115.8	5' - 10': Brown sandy Silt (ML) w/ little clay to silty, clayey fine Sand (SC-SM), moist.	
10	R-3	66				16.7	109.5		
								- Depth of drilling 10 feet below the existing paved surface. - Groundwater was not encountered. - After logging & sampling, drilled hole was backfilled w/ the excavated soil spoils and surface was patched w/ cold mix asphalt on 11/25/20.	
SOUTHWEST #200381								LOG OF BORE HOLE B-1	

[illegible]

DRILLING DATE: 11/25/20 DRILLING METHOD: Truck Mounted CME-75 Drilling Rig; 7" Dia. Hollow Stem Auger

LOGGED BY: MF/GA ELEVATION: ~557 ft LOCATION: See Fig. 2a, Site Plan & Exploration Map

CAMPUS ENTRANCE IMPROVEMENTS RSCCD SANTIAGO CANYON COLLEGE 8045 E. CHAPMAN AVENUE, ORANGE, CA 92869								SOIL TESTS
DEPTH (FEET)	SAMPLE NUMBER	BLOWS/FOOT	RING SAMPLE	SPT SAMPLE	BULK SAMPLE	MOISTURE CONTENT (%)	DRY DENSITY (PCF)	
BORE HOLE NO. B-2								
SOIL DESCRIPTIONS								
1.5	R-1	68				12.4	122.8	Surface is concrete paved, 4" concrete over 3" base.
3	R-2	99				12.7	114.1	0.58' - 4': Brown sandy Silt (ML) w/ trace clay, fine sand, sand, moist.
5	R-3	41				20.7	114.7	4' - 10': Reddish brown to dark brown sandy Silt (ML) w/ little clay to silty, clayey fine Sand (SC-SM), moist.
10								
								- Depth of drilling 10 feet below the existing paved surface. - Groundwater was not encountered. - After logging & sampling, drilled hole was backfilled w/ the excavated soil spoils and surface was patched w/ rapid set concrete on 11/25/20.
SOUTHWEST #200381								LOG OF BORE HOLE B-2

SECTION 32 96 43

TRANSPLANTING TRUE DATE PALMS

Transplanting Canary Island and True Date Palms

1.0 GENERAL CONDITIONS

- A. Inspect the site where the palm is going to be transplanted. If proper drainage is in place, it is almost impossible to over water a palm. Good drainage will minimize the risks involved with improper irrigation.
- B. To insure that the planting hole has positive drainage it is important to perform a field percolation test at the landscape site prior to planting.
 - 1. This is done by excavating a hole that is 16-24 inches wider than the boxed palm being used (for example a 36" box requires a 60" square planting hole that is 6" deeper than the depth of the root ball). This planting pit is then half-filled with water. In 24 hours all of the water should have drained out of the hole. If this occurs then no extra drainage consideration need to be taken. **Note: never leave an open planting pit overnight without securing a plywood cover over it to prevent injury.**
 - 2. If there is still water in the planting pit after 24 hours then a method of positive drainage needs to be implemented. The best method is to connect all of the planting pits together with 3" perforated Schedule 40 P.V.C. pipe covered with a fabric filter (sock). This pipe should be placed in the planting pit 6" below the root ball and then covered with washed concrete sand. Run the pipe from the planting pits with a solid P.V.C. pipe to a storm drain (if code allows) or in a manner that allows excessive water to run-off.
 - 3. Install a perforated P.V.C. pipe (socked) "standpipe". The perforated pipe should touch the bottom of the planting pit. It is preferred two standpipes in a "U" shape that goes under the palm root ball. The connected standpipes should extend above the finish grade. They will be cut off even with the graded soils and have a grated cap installed after planting.
- C. Dig the planting pit two times the diameter of the root ball (six-foot minimum width for Canary Island Dates, 4-1/2 to 5 feet for True Dates) with vertical sides (not diagonally sloped). Remove and discard all soil in the planting pit if replacing a diseased palm. Roughen the sides and bottom of the planting pit.
- D. Plant the new palm at the same level at which it was originally grown. Never plant deeper than the top of the root initiation zone.
- E. Backfill the planting pit with clean-washed plaster sand, to provide a well-draining medium. Also, soils amendments are generally not recommended (if the backfill material is much better than the surround existing soil, then the new roots of the palm may never penetrate the adjacent existing soil and will just keep encircling around the inside of the original planting pit).
- F. During the backfill process, thoroughly water-in (jet) the backfill material in 12" levels to ensure that air pockets and voids are filled, and to create a solid union from the root ball to the backfill mix to the existing soil.

- G. After planting, install a 4” height soil berm around the perimeter of the planting pit to create an enclosed water basin.
- H. Install multiple drip or bubblers at the soil surface just inside the root ball / backfill interface so that wash is directed to the root ball. The irrigation system should be on a separate zone and capable of delivering 60-80 gallons of water a day (although this amount will rarely be used).
- I. Continual monitoring of the moisture level of the soil in the root zone is a critical element to ensure survival, especially in the first few months after planting:

Immediately after planting, water each palm to the full depth of each planting pit, ensuring water saturation throughout the entire soil profile (this is easily accomplished if the backfill is jetted-in with water as the palm is planted). Natural drainage will then create “field capacity” conditions.

Never let the soil dry out during the establishment period (which could be 1-2 years minimum). However, never over water either since that can create an environment that suffocates roots due to a lack of oxygen in the root zone. Over-watering can also create a host environment for disease pathogens such a Phytophthora root rot (also called “Bud Rot” since the visible symptom of the diseased roots is a rotten bud on the palm) and secondary root pathogens such a Pythium.

An on-going process of achieving field capacity in the soils profile (i.e. total water saturation that has been naturally drained), then allowing the soil to dry out to a certain level, and then achieving field capacity again is the ideal watering method. A fine line must be maintained to ensure adequate but not excessive moisture in the root zone throughout this process.

- J. Transplanted palm trees are to remain in their existing locations until the new locations are prepared. Palms that cannot be transplanted immediately can stay out of the soil for up to 36 hours before they must be planted in their final location. Palms out of the soil for more than 4 hours must be protected from the elements until they are relocated to their final location. If locations of existing palms cause significant hardship to the contractor during the course of construction, or if construction activities will overly stress the existing palm trees to be transplanted, the contractor may plant the palm trees in a temporary location assuming the final proposed location is not yet available. Preparation of the temporary location of the palm tree to be per specification section 32 93 44 and detail 6, sheet L-7.02. Contractor is not required to connect temporary palm planting locations to the stormdrain system, but will need to include temporary observation pipes and monitor the palms daily to ensure adequate soil drainage. All transplanting of palms to be done under the care of an ISA master arborist and palm specialist such as Gregston Young, (760-250-1229). All other ISA master arborist and palm specialists to be pre-approved by architect.
- K. Location of temporary palm locations to be per district direction. Location of temporary palm locations to be reviewed and approved by architect and palm specialist prior to start of construction and relocation. If an acceptable on-site location cannot be determined, the contractor shall procure new replacement palms to match existing. Size and type to be specified by the architect.

Addendum#1 - Revised Electrical Sheets



Santa Ana + Oakland + San Diego + Honolulu

SVA Architects, Inc.

6 Hutton Centre Drive, Suite 1150
Santa Ana, California 92707
T 949.809.3380

info@sva-architects.com
www.sva-architects.com

ADDENDUM 02

March 13, 2025

Project: SANTIAGO CANYON COLLEGE BARRIER REMOVAL CAMPUS ENTRANCE IMPROVEMENTS – PHASE 2

Orange, CA

Owner: RANCHO SANTIAGO COMMUNITY COLLEGE DISTRICT
2323 North Broadway, Suite 112,
Santa Ana, CA 92706

Architect: SVA Architects
6 Hutton Centre Drive, Suite 1150
Santa Ana, CA 92707

DSA App. No.: 04-122457

Note: The following revisions and clarifications to the Approved Documents (plans and specifications) shall become a part of the Contract Documents prior to Bid. The narrative descriptions listed for the changes are provided for general reference as to the revisions, and each revised drawing/specification/bid package/bid document included shall be reviewed for the full extent of revisions.

DRAWINGS

Delete the listed sheets below and replace them with the sheets attached as part of this addendum.

1. **FOUNTAIN DESIGN:**

Delete the listed sections below and replace them with the sheets attached as part of this addendum addressing the bid RFIs pertaining to the fountain design.

- A. **F-1.05 – Detail 1:** The wiring and conduit for the light power supplies have been relocated to the West J-box for ease of installation.
- B. **F-1.05 – Detail 2:** Filter pumps have been included in the detail.
- C. **F-1.06 – Detail 1:** The electrical plan has been updated to reflect new light fixtures and power supply layout. The originally specified lights are no longer available.



- D. **F-1.07 – Details 1 thru 4:** The electrical schematics have been updated to include the three new lighting circuits.
- E. **F-1.07 – Detail 2:** Float switch detail has been included.

Attachments: Revised Sheets: F-1.05, F-1.06, and F-1.07

Reason: Clarifications for bidders.

Distribution: District
File

END OF ADDENDUM 2

THIS DOCUMENT IS THE PROPERTY
OF RJM DESIGN GROUP, INC., AND
NO PART THEREOF SHALL BE USED
REUSED, OR MODIFIED WITHOUT THE
WRITTEN CONSENT OF RJM DESIGN
GROUP, INC. ©2020 RJM Design
Group, Inc. All rights reserved.

DC POWER CONNECTION CABLE
SUBMERSIBLE, 3 METER LONG
QASE 12552
(TYP. 8)

POWER CONNECTION BOX, FOUR
PORT, 24 VOLT.
QASE 47930
(TYP. 8)

LIGHTING FIXTURE, LED, 24
VDC, 24 WATT.
PROFILUX BASIC LED L W
FLOOD.
QASE 72664
(TYP. 24)

POWER SUPPLY, SUBMERSIBLE,
24VDC/10.5AMP OUTPUT, 120
VAC/2.3AMP INPUT.
UVPS 250/24V/02
QASE 40289
(TYP. 7)

Addendum#1 - Revised Electrical Sheets

JUNCTION BOX, SUBMERSIBLE,
W/ 8x 1/2" NPT SIDE TAPS, 8
1x 1" NPT BOTTOM TAP, .45
CU/IN, BRONZE, O-RING SEAL
ELLIOTT J88 (85709)
(TYP. 2 THIS DETAIL)

LIGHTING FIXTURE, LED, 24
VDC, 56 WATT.
PROFILUX BASIC LED XL W
FLOOD.
QASE 72666
(TYP. 16)

LOW LEVEL PROTECTION FLOAT
SWITCHES, TYP. BOTH LEVELS
SEE DETAIL.

① FOUNTAIN LIGHTING ELECTRICAL PLAN
Scale: 3/8" = 1'-0"

FCA (208 volt bus)		GFCI	LIGHTING RECEPTACLE	OTHER					Breaker, MMS,or CC Fuse.	
208Y120volt / 3ph / 4wire / 60Hz / 10kAIC Fused at 50 amps Location: Pedestal near fountain						L1	L2	L3		
Cir:	Desc:				fla	VA	VA	VA	Poles:	Amps:
1	Display pump 1 (2hp)	X		X	6.4	769			3	20
	*						769			
	*							769		
2	Display pump 2 (2hp)	X		X	6.4	769			3	20
	*						769			
	*							769		
3	Display pump 3 (2hp)	X		X	6.4	769			3	20
	*						769			
	*							769		
4	Display pump 4 (2hp)	X		X	6.4	769			3	20
	*						769			
	*							769		
5	Display pump 5 (2hp)	X		X	6.4	769			3	20
	*						769			
	*							769		
6	Display pump 6 (2hp)	X		X	6.4	769			3	20
	*						769			
	*							769		
7	Display pump 6 (2hp)	X		X	6.4	769			3	20
	*						769			
	*							769		
8	Display pump 6 (2hp)	X		X	6.4	769			3	20
	*						769			
	*							769		
9	Filter pump 1 (2hp)	X		X	7.7	925			3	20
	*						925			
	*							925		
10	Filter pump 2 (2hp)	X		X	7.7	925			3	20
	*						925			
	*							925		
11	Lighting circuit 1	X	X		2.1	250			1	15
12	Lighting circuit 2	X	X		2.1		250		1	15
13	Lighting circuit 3	X	X		2.1			250	1	15
14	Enclosure fan	X		X	2.1	250			1	15
15	Receptacle	X		X	2.1		250		1	15
16	Control circuit	X		X	2.1			250	1	15
Subtotals:					8,497		8,497	8,497		
Total VA: 25,491										
Voltage: 208										
Amperage: 71										
Phase: 3										
Service (minimum): 89										
Service (selected): 100										

② ELECTRICAL LOAD SCHEDULE
Scale: None

③ NOT USED
Scale: None

OWNER: RANCHO SANTIAGO COMMUNITY COLLEGE DISTRICT

PROJECT NAME: SANTIAGO CANYON COLLEGE
CAMPUS ENTRANCE IMPROVEMENTS PROJECT
PHASE 2

PROJECT ADDRESS: 8045 E. Chapman Avenue, Orange, CA 92669

REVISIONS:

	DESCRIPTION	DATE
△	ADDENDUM 2	03/13/2025
△		
△		
△		
△		
△		
△		
△		
△		
△		

PROJECT NO: 2018-40167
DATE ISSUED: 2018-11-19
SCALE: As indicated

SHEET
NUMBER:

SHEET TITLE:

FOUNTAIN
ELECTRICAL
PLANS &
DETAILS

RJM DESIGN GROUP



31591 Camino Capistrano
San Juan Capistrano, CA 92675
www.RJMDesigngroup.com
(949) 453-2650 fax
(949) 453-2600 phone

THIS DOCUMENT IS THE PROPERTY
OF RJM DESIGN GROUP, INC., AND
NO PART THEREOF SHALL BE USED,
REUSED, OR MODIFIED WITHOUT THE
WRITTEN CONSENT OF RJM DESIGN
GROUP, INC. ©2020 RJM Design
Group, Inc. All rights reserved.

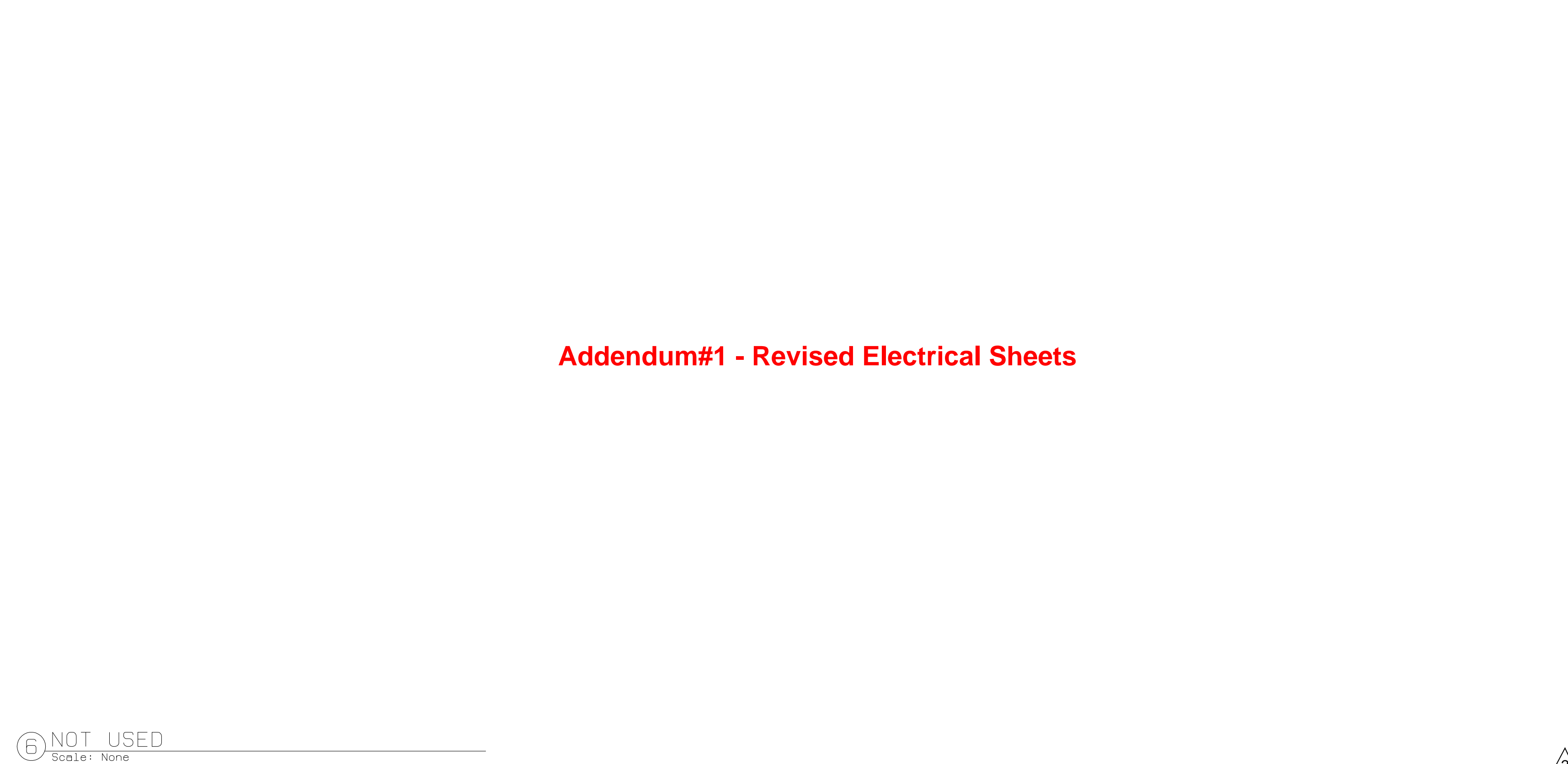
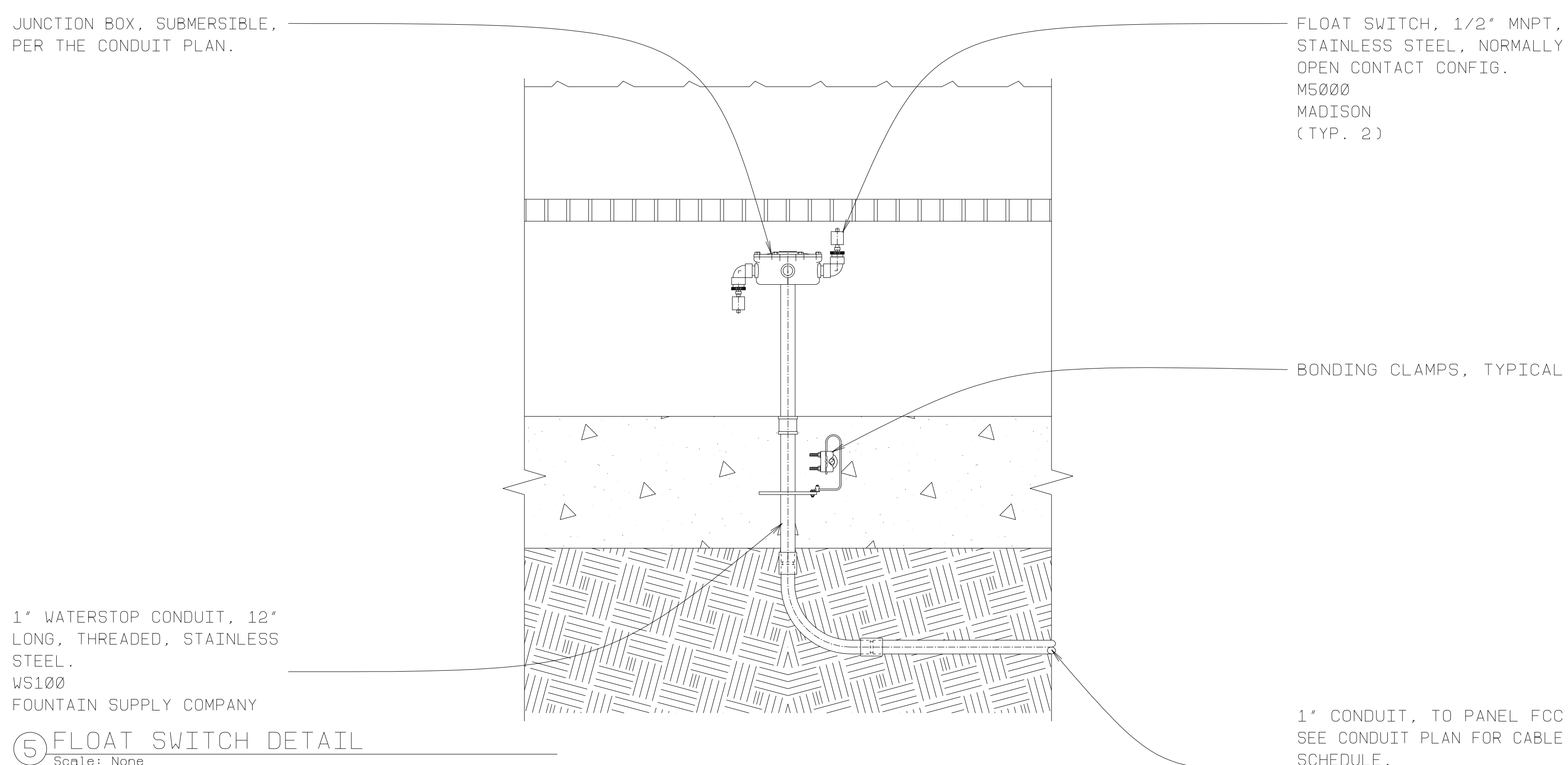
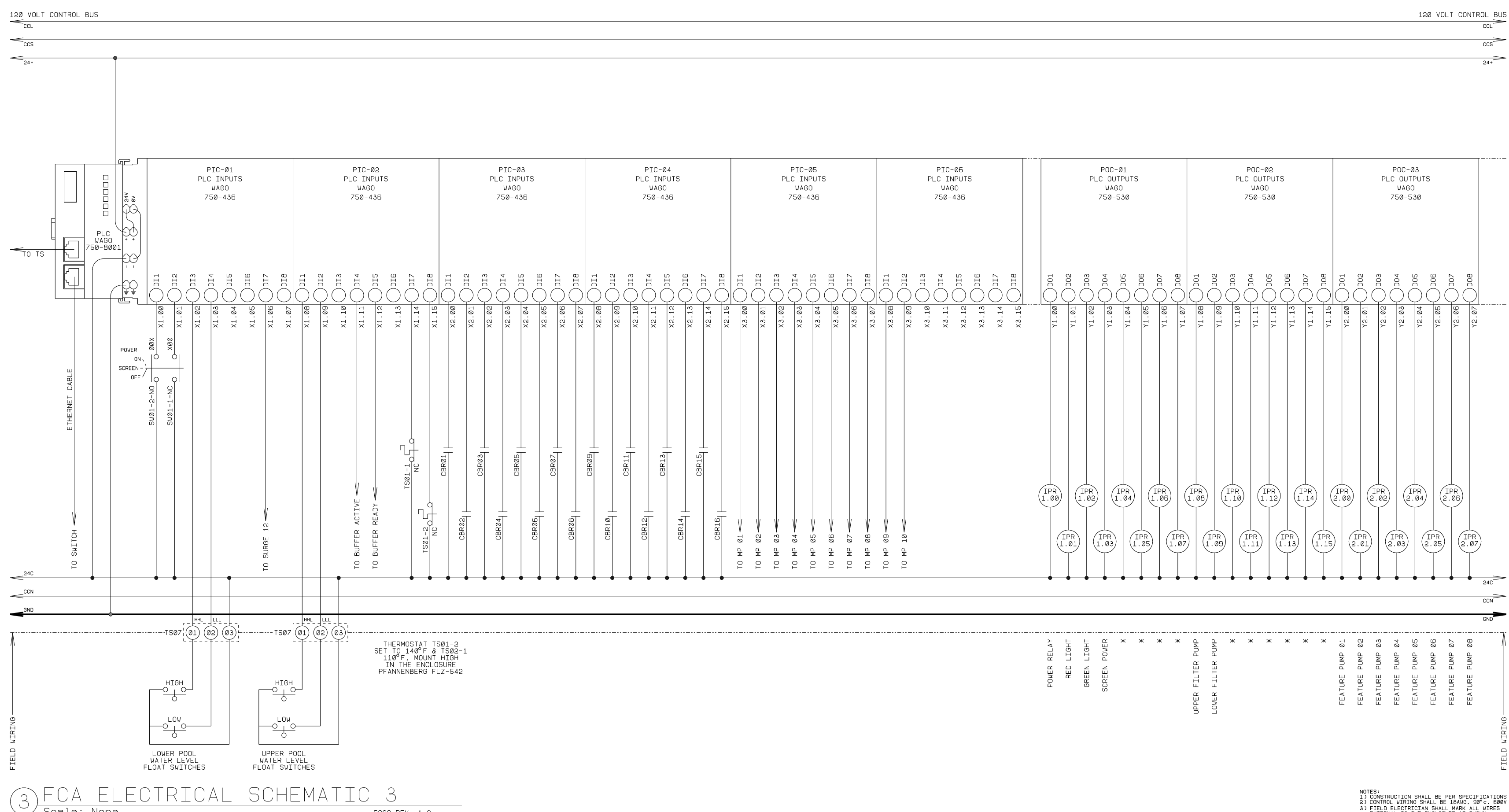
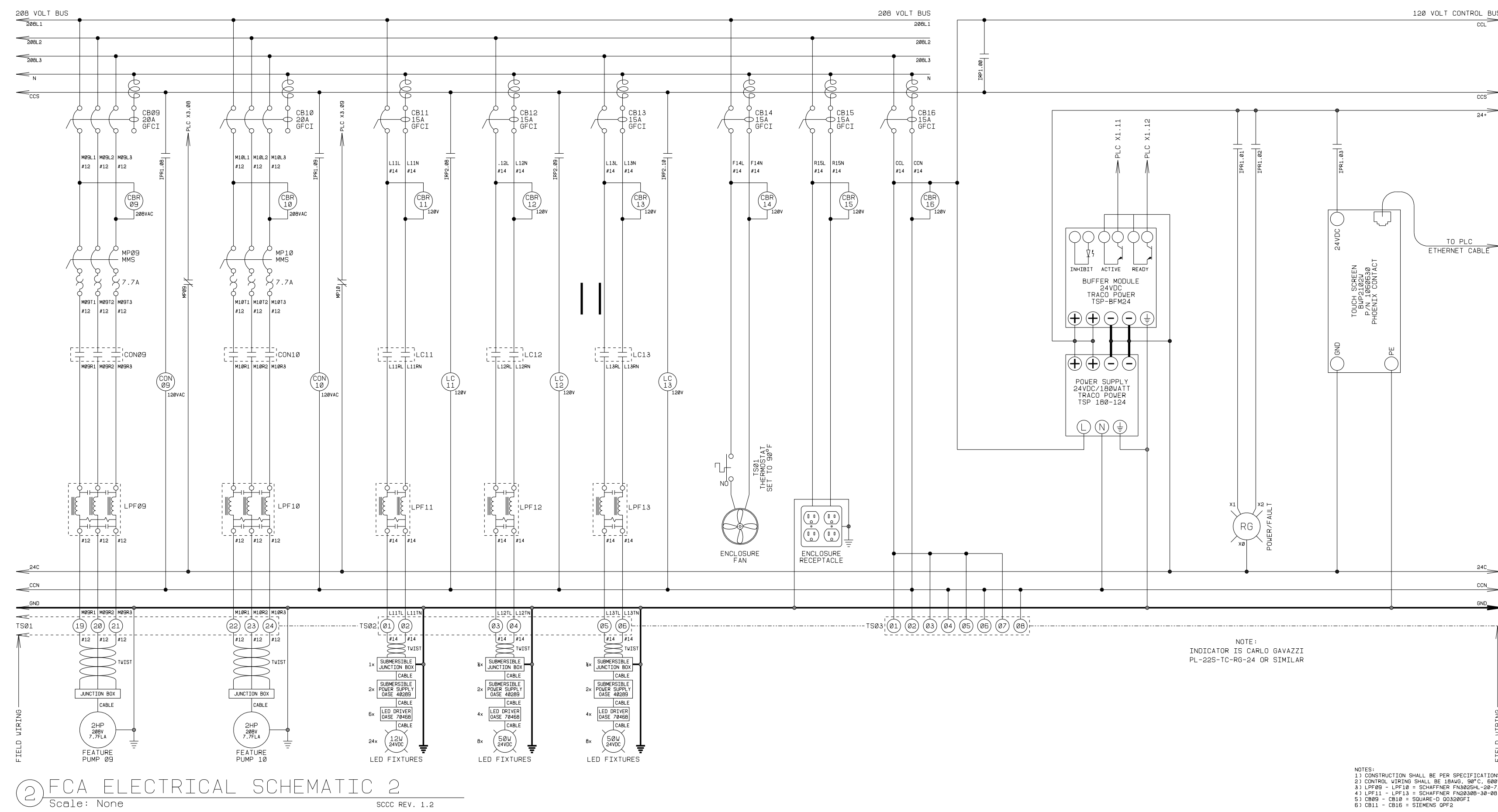
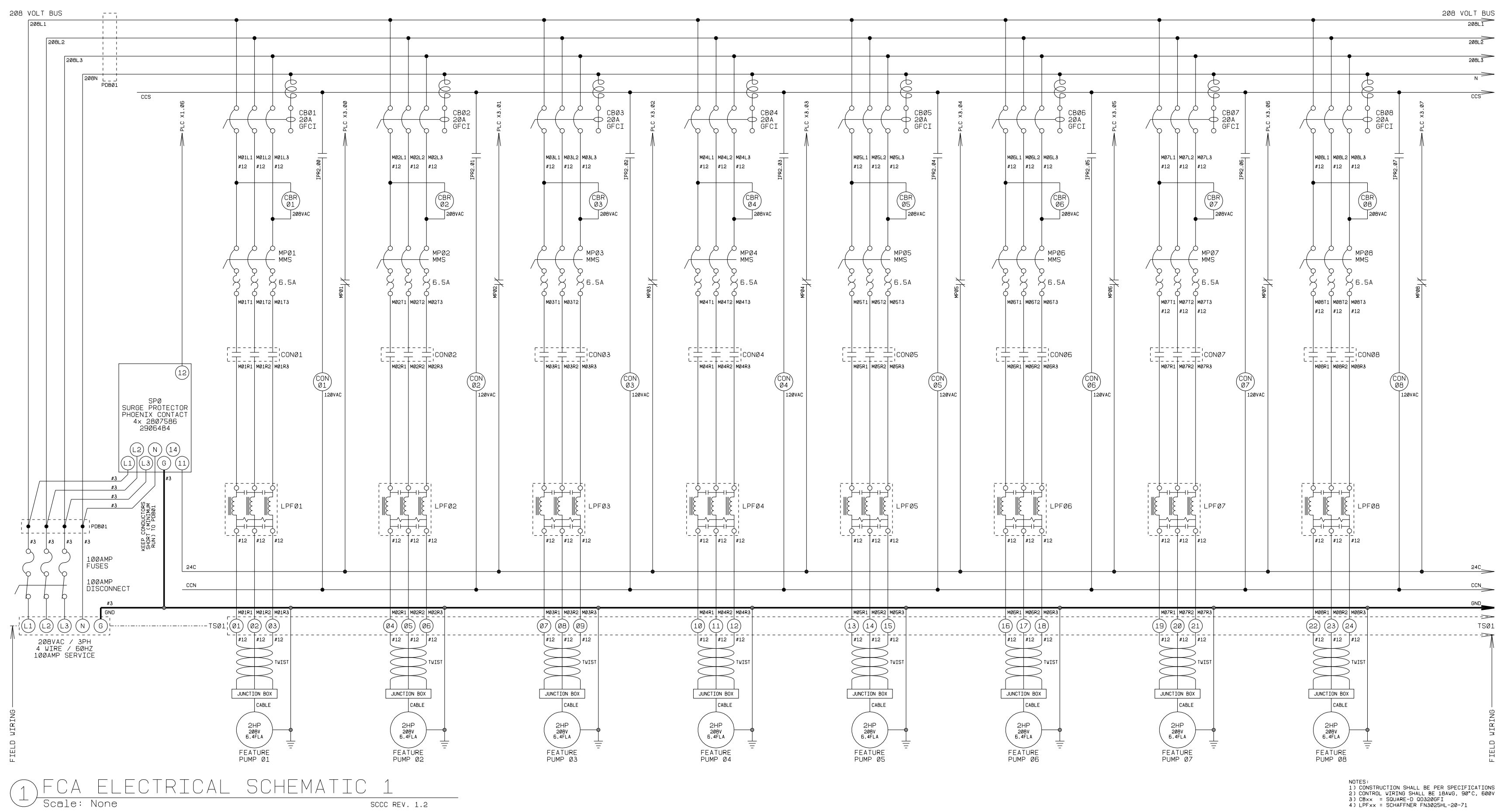

Addendum#1 - Revised Electrical Sheets

OWNER: RANCHO SANTIAGO COMMUNITY COLLEGE DISTRICT

PROJECT NAME: SANTIAGO CANYON COLLEGE
CAMPUS ENTRANCE IMPROVEMENTS PROJECT
PHASE 2

PROJECT ADDRESS: 8045 E. Chapman Avenue, Orange, CA 92669

REVISIONS:

DESCRIPTION	DATE
ADDENDUM 2	03/13/2025

PROJECT NO: 2018-40167
DATE ISSUED: 2018-11-19
SCALE: As indicated

SHEET NUMBER: F-1.07
SHEET TITLE:

FOUNTAIN ELECTRICAL SCHEMATICS